



Bullet Resistant Equipment

Creative Industries Inc

Package Receiver



Package Receiver available with Class I and III bullet resistant protection.
 Clear inside dimensions:
 14 3/4" wide x 13 1/8" high x 15 1/2" deep.

Package Receiver accommodates larger items for transfer. It has inter-locking mechanism to allow only one door at a time to open. Front door can be locked from rear side with special locking bar. Closer is furnished on front door.

Package Receiver mounts into wall up to 11 1/2" thick. Adjustable frame on interior side mounts against wall in field. Exterior flange has rain cap along top edge.

Finish options: Stainless steel doors with prime painted housing.
 Prime painted doors and housing.

Wall opening size: 15 1/2" wide x 15 1/2" high.

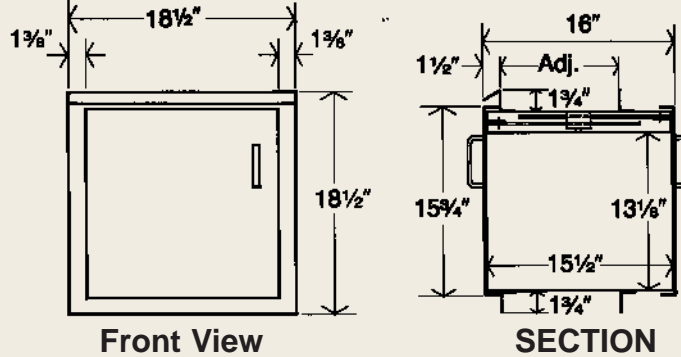

Package Receiver with Vision Panel PR-VP



It is same as standard package receiver above except vision panel in rear door enables operator to see contents inside unit.

Construction: Prime painted steel housing and stainless steel doors.

Vision panel: Class I - 1 1/4" acrylic or Class III - 1 1/4" Lexgard.

Clear inside dimensions: 14 3/8" wide x 13 1/8" high x 14 3/16" deep.

Wall opening size: 15 1/2" wide x 15 1/2" high.

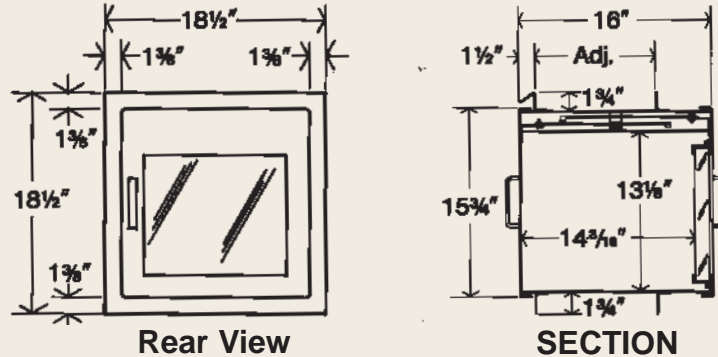

Clear Package Receiver

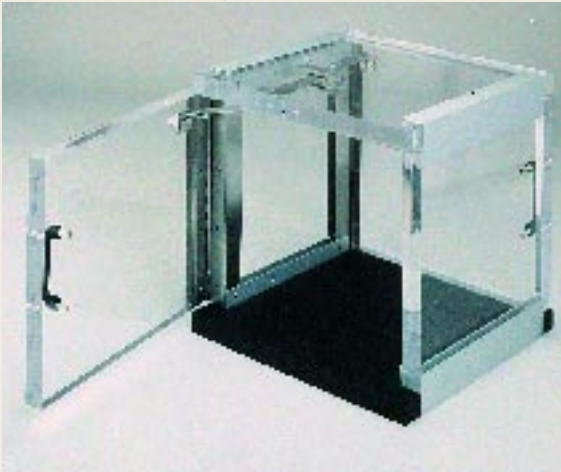

Clear Package Receiver is for interior use only. Clear acrylic housing is fastened together with special aluminum extrusions. Clear acrylic doors allow plain view of contents. Bottom is made of plastic laminated plywood and bullet resistant fiberglass. Unit mounts on counter top. Special inter-locking mechanism allows only one door at a time to open.

Class I or III bullet resistant protection.

Clear inside dimensions: 13 5/16" wide x 12 1/2" high x 13 3/8" deep.

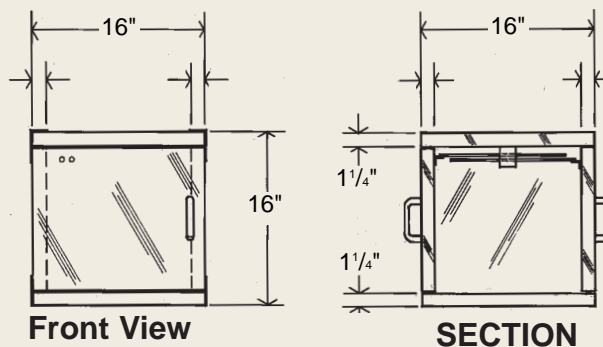

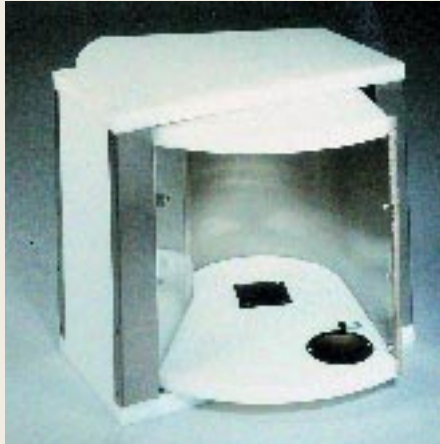

Carri Bell delivers fast repetitious service for long periods of time. Its operating motion is probably the quickest of our pass thrus

The bell shaped drum pivots outward to customer, then inward to operator. Drum locks with a drop bolt. Carri Bell has stainless steel inner walls, bullet resistant plastic on top, bottom, shelf and exterior sides. Operator's side has clear acrylic panel for full view of contents. Class I bullet resistant protection. Carri Bell is large enough for a 24 pack of canned beverage, 3 gallons of milk, 4 gallons of antifreeze or 7 two liter bottles.

Options: Clear panel for customer's side.
Weatherstrip for exterior use.

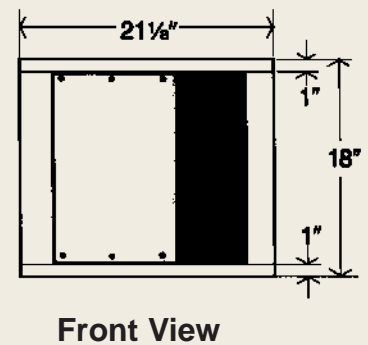
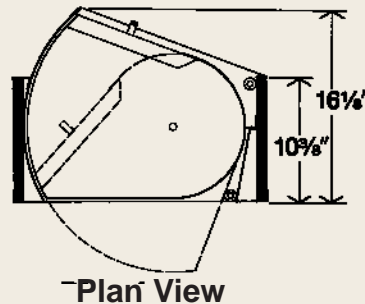

Exterior Lazy Susan LSW-CR

Exterior Lazy Susan is equipped with weather-strip for outdoor use eliminating direct entry of outside air into the building. This unit has stainless steel sides and inner drum with a clear acrylic window for viewing of contents. Top and bottom are bullet resistant plastic. Only one moving part - the inner drum - rotates with smooth movement. Crank handle on top turns the drum 180 degrees. Lazy Susan locks with a drop bolt. In locked position the stainless steel drum is turned to customer for maximum security. Unit mounts on counter top or in wall opening.

Class I bullet resistant protection. Standard sizes are listed below.

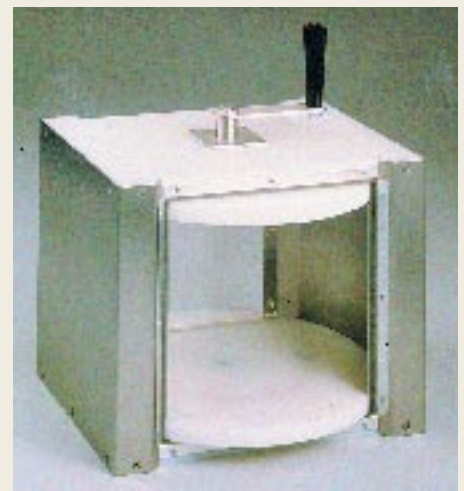

LSW-CR 1512 is large enough for six pack of drinks or gallon of milk.

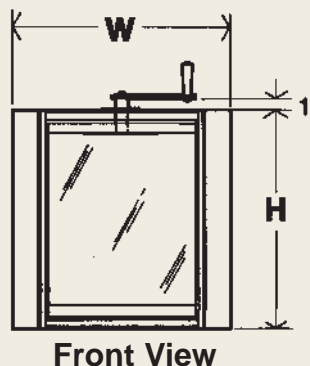
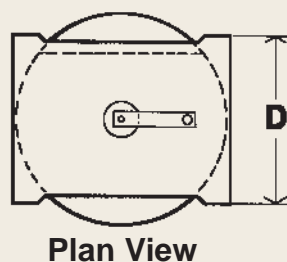
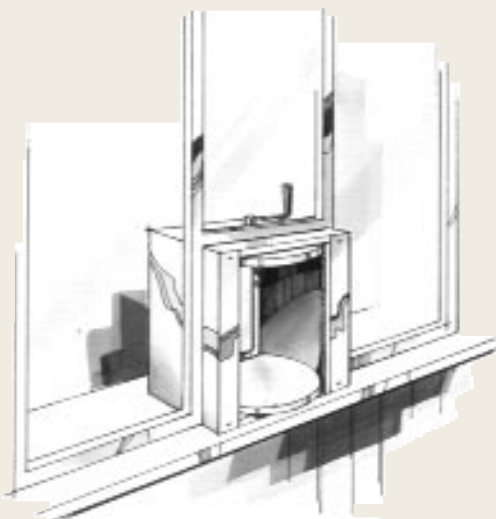

Model	W	H	D
LSW-CR 1512	15"	12"	11 ⁵ / ₈ "
LSW-CR 1820	18"	20"	13 ⁷ / ₈ "
LSW-CR 2418	24"	18"	18"
LSW-CR 2618	26"	18"	19 ⁵ / ₈ "

Pass Hoppers

All stainless steel Pass Hopper mounts on counter top, in wall or window opening. Hopper pivots outward for customer access, then in opposite direction for operator access. Only one moving part allows virtually maintenance free service. Pass Hopper is equipped with weatherstrip for exterior use. Standard models provide Class I bullet resistant protection. Class III protection is an extra option.

Pass Hopper is available with stationary exterior flange and loose adjustable flange for rear side.



Pass Hopper with flange.

Pass Hopper PHE-1

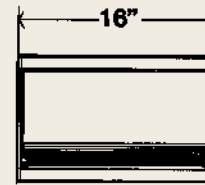

Front View

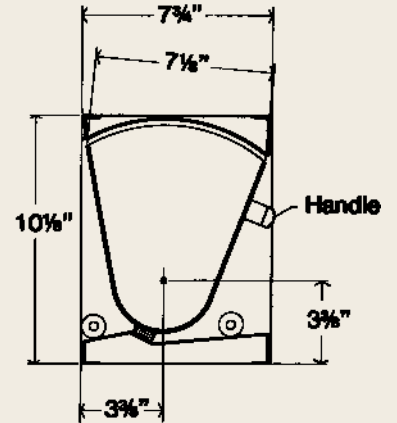

SECTION

Pass Hopper can handle a gallon of antifreeze, two liter beverage or bag of coins. Hopper locks with latch.

Pass Hopper PHE-2



Front View

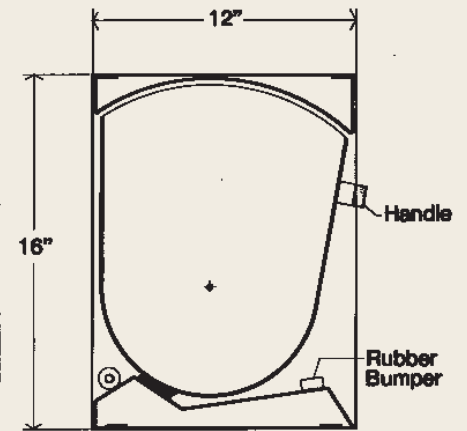

SECTION

Largest pass Hopper provides ample capacity for larger bulky items. Equipped with stainless steel handle and round turn latch.

Pass Hopper PHE-3

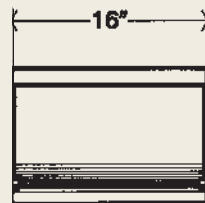

Front View

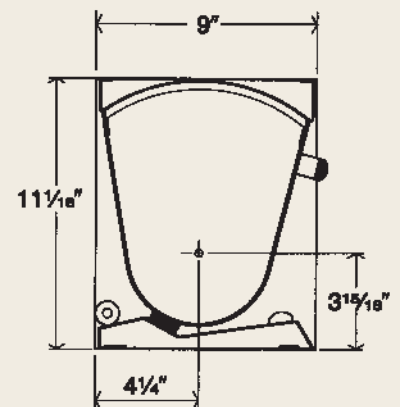

SECTION

Pass Hopper can accommodate a three liter beverage or gallon of milk.



For drive-up or walk-up service, Safti Server provides bullet resistant protection while holding energy loss to a minimum. It allows no direct entry of outside air into the building.

Safti Server has only one moving part (the shelf) which turns both inward and outward to allow access to contents. Shelf extends approximately 15" from face of building when turned to customer.

Safti Server locks with the two adjacent acrylic doors forming an insulated barrier between outside and inside air. Unit mounts on window ledge, in wall opening or on counter top.

It has clear inside height of 14 1/2". Top, bottom and shelf are bullet resistant plastic. Sides are clear or bronze anodized aluminum. Doors are clear 1 1/4" thick acrylic.

Class I bullet resistant.

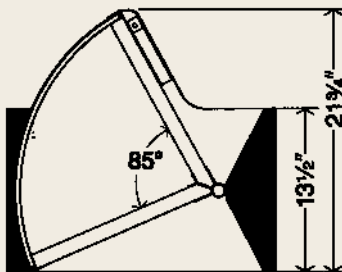

Plan View

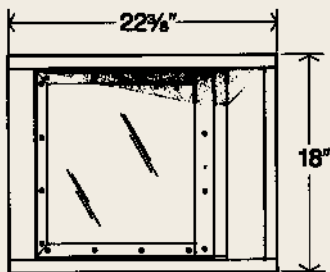

Front View

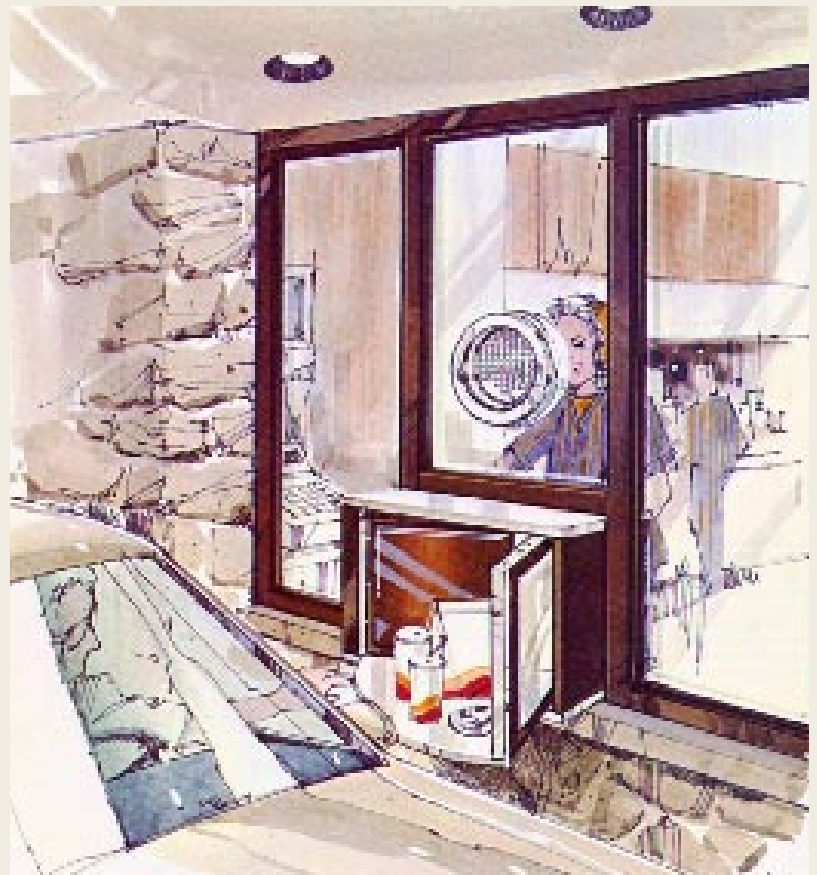

Transaction Drawer 1924-DD

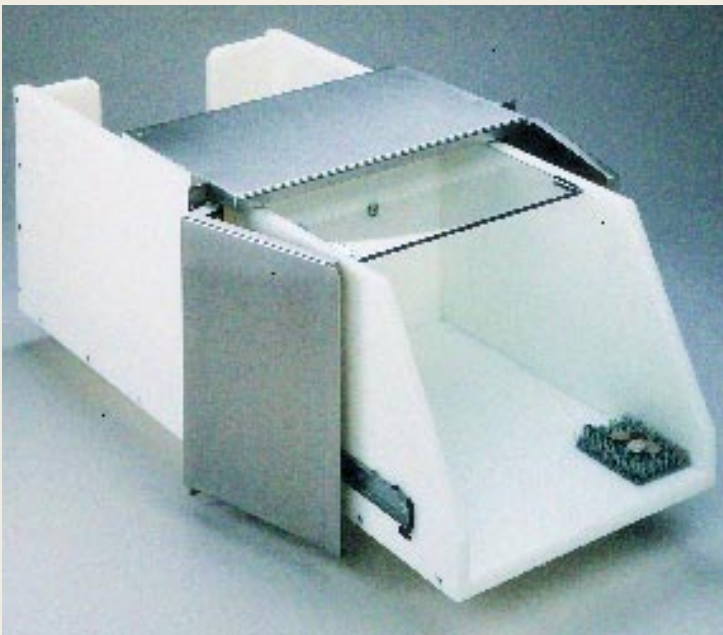

1924-DD Transaction Drawer is bullet resistant and weather resistant. It is well suited for drive-up service. Drawer moves on heavy duty ball bearing slides and the front doors open as drawer is extended. The drawer locks automatically when closed. Lexan lid permits clear view inside drawer and remains closed when drawer is open to customer. Bill clip and coin pad are furnished inside drawer to hold currency.

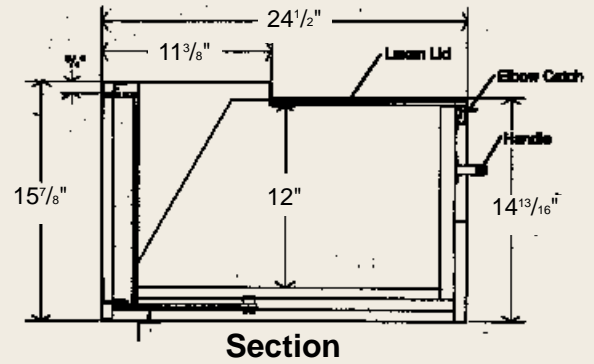
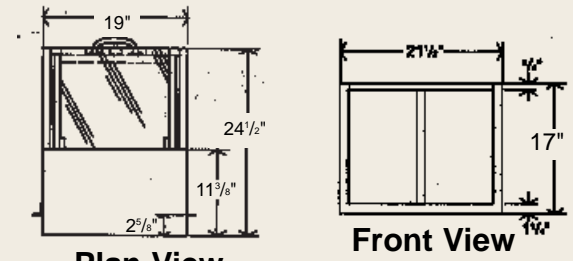

Drawer can be mounted in wall up to 8 5/8" thick. Drawer and housing are constructed of bullet resistant plastic. Doors, hood and flange are stainless steel. Drawer inside dimensions: 14 1/2" wide x 12" high X 20" deep. Drawer extensions: 15 1/2". Wall opening size: 19 1/4" wide x 16 1/2" high. Class I bullet resistant.

Slide Top ST 1620

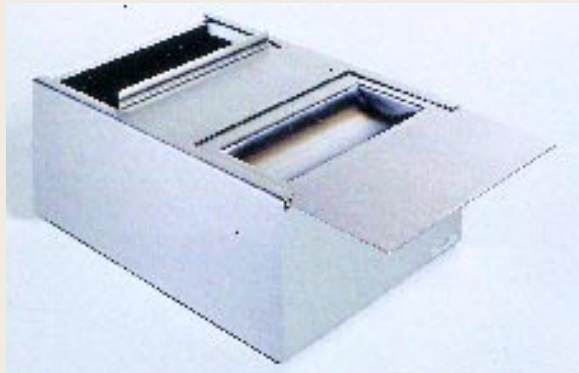
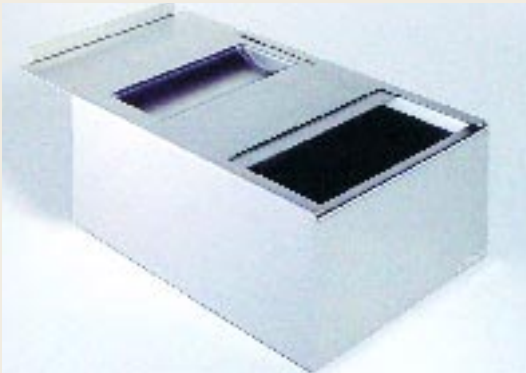

Slide Top serves both as deal tray and pass thru. Recessed deal tray in center of sliding lid moves forward or backward beneath the center ledge for transaction of currency and small items. Bulkier items can pass through the larger cavity below.

Slide Top is constructed of stainless steel. It can be mounted in wall opening or on counter, with window centered above the center ledge. Available in 8 inch or 10 inch height.

Unit is Class I bullet resistant.

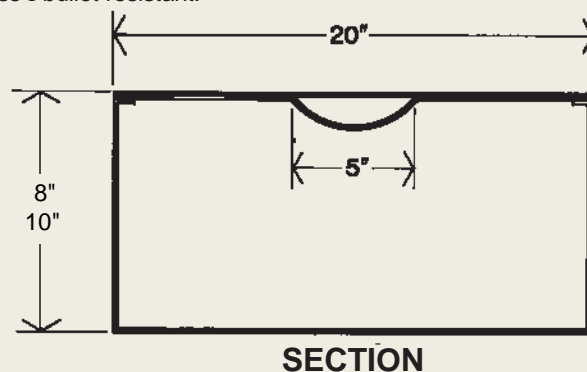
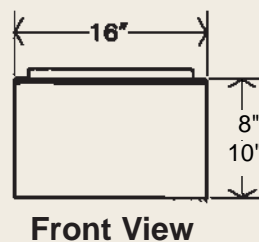
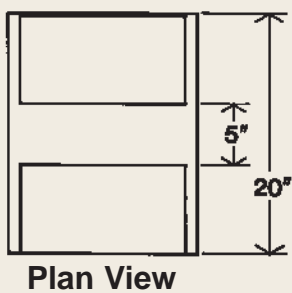

Deal Drawers

Deal Drawer recesses in counter top along front to achieve flush appearance. Glazing (by others) sets above the flat hood portion of drawer. Full width handle across rear of drawer along with smooth solid bearing slides allows easy operation. Lexan lid stays closed when drawer is extended. Drawer unit has stainless steel construction.

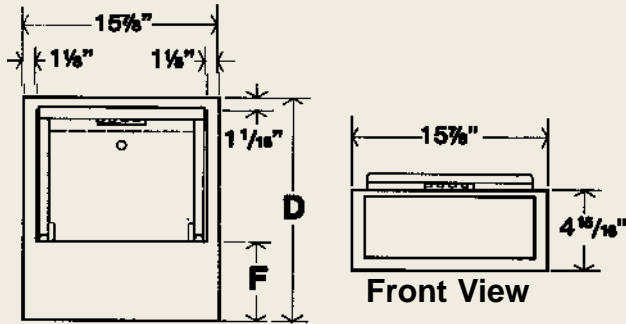

Plan View

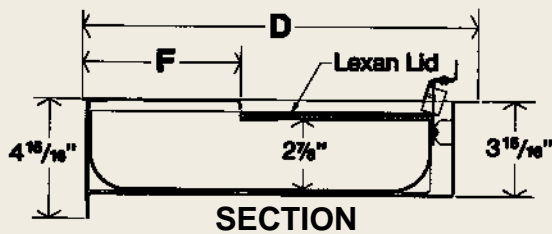

SECTION

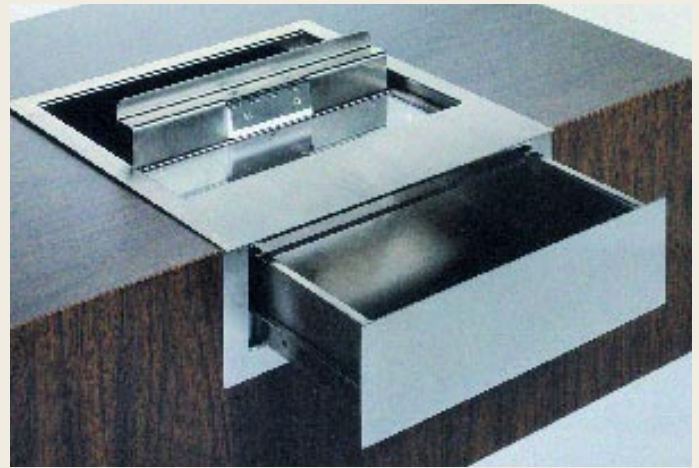

Model	F	D	Cut out size		
			W	D	H
1616	6 1/2"	16 1/4"	14 1/2"	15"	4"
1620	6 1/2"	20 1/4"	14 1/2"	19"	4"
1622	8"	22 1/4"	14 1/2"	21"	4"

Cash Drawer 1618

Cash Drawer has stainless steel housing with bullet resistant plastic drawer. Unit mounts in counter top along front edge. Glazing (by others) should set above the flat hood portion of drawer. As drawer slides out the stainless steel front panel pivots upward. Movement is controlled by the full width handle across rear of drawer. Lexan lid stays closed when drawer is extended. This unit is designed for long life as there are no slides to wear out.

Counter top opening size: 14 1/2" wide x 17 1/8" deep x 5 3/4" high.
Drawer extension: 9"

Inside dimensions of drawer: 12" wide x 14 5/8" deep x 3 5/8" high.

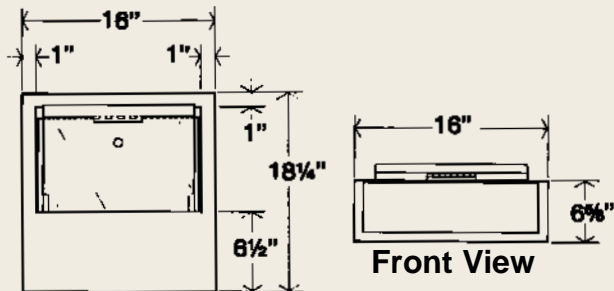

Plan View

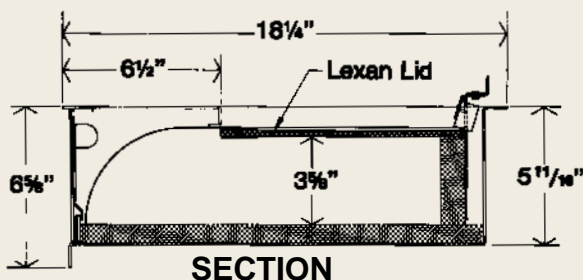

SECTION



A Series Transaction Drawers

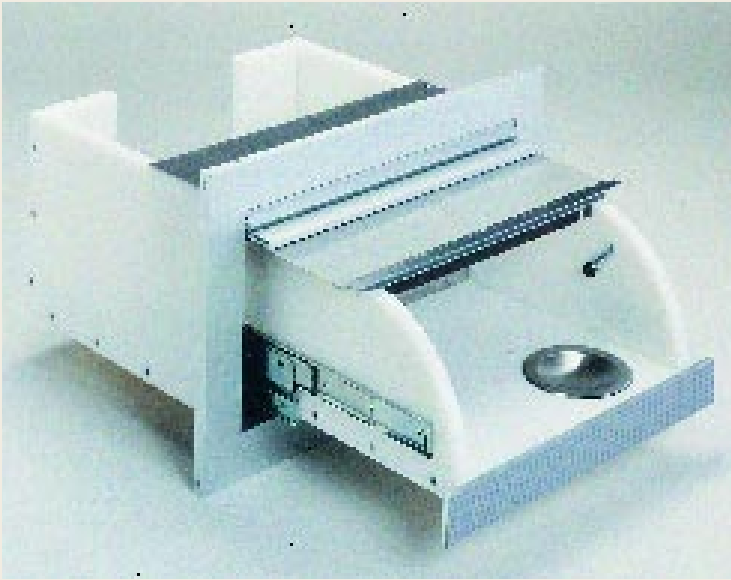

A Series Transaction Drawers are weather resistant as well as bullet resistant. The front stainless steel panel pivots upward as drawer moves outward. Drawer movement is provided by smooth extension slides. It locks with drop bolt. Drawer unit has aluminum frame and stainless steel hood with bullet resistant plastic construction. Lexan lid stays closed as drawer is extended.

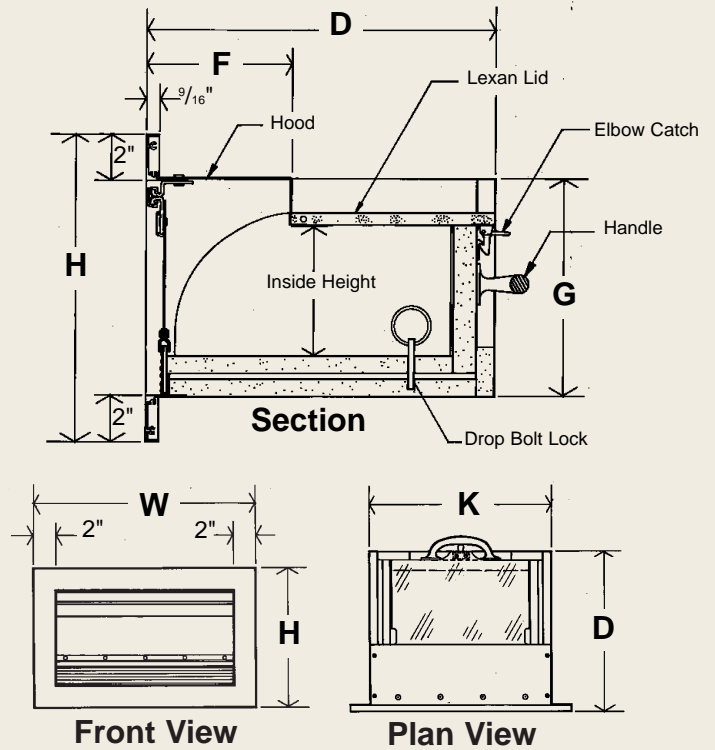

Model	Overall Size						Inside Drawer Dimensions			Wall Opening
	W	H	D	F	G	K	Width	Height	Depth	Width x Height
1715A	20 ⁷ / ₈ "	13 ¹ / ₈ "	15"	6 ¹ / ₄ "	9 ⁷ / ₁₆ "	17"	12 ³ / ₄ "	5 ¹ / ₄ "	12 ³ / ₈ "	17 ¹ / ₂ " x 9 ⁵ / ₈ "
1818A	21 ⁷ / ₈ "	15 ⁵ / ₈ "	18"	7 ⁵ / ₈ "	11 ¹¹ / ₁₆ "	18"	13 ³ / ₄ "	7 ¹ / ₂ "	15 ³ / ₈ "	18 ¹ / ₂ " x 12"
1824A	21 ⁷ / ₈ "	18 ³ / ₄ "	24"	10 ³ / ₄ "	14 ¹³ / ₁₆ "	18"	13 ³ / ₄ "	10 ⁵ / ₈ "	21 ³ / ₈ "	18 ¹ / ₂ " x 15 ¹ / ₈ "
2725A	21 ⁷ / ₈ "	14 ³ / ₄ "	24 ³ / ₄ "	11 ¹ / ₄ "	11 ⁵ / ₁₆ "	27"	22 ³ / ₄ "	7 ³ / ₈ "	22 ¹ / ₈ "	27 ¹ / ₂ " x 11 ⁵ / ₈ "

1724 WW and 1728 WW Transaction

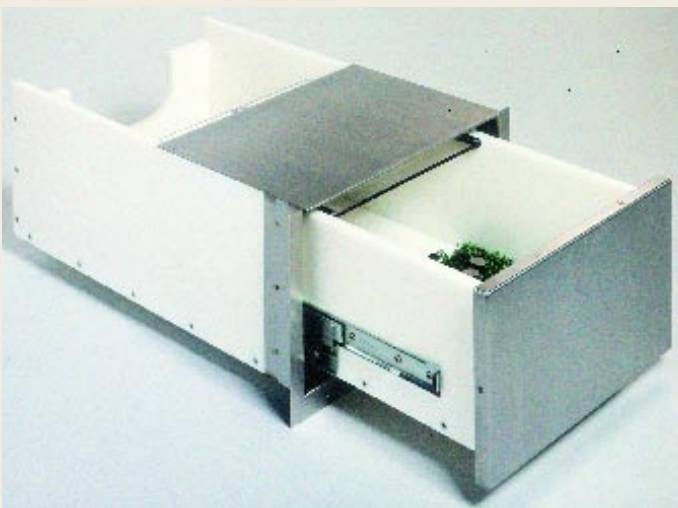

WW Series Transaction Drawer is designed with exterior walk-up service in mind. It has an extra deep stainless steel hood which enables it to fit thicker walls. The Lexan lid prevents direct entry of outside air while allowing clear view of drawer interior. Drawer movement is controlled by a large aluminum handle on rear. Front of unit is stainless steel. Easy operation is allowed by smooth running ball bearing extension sides.

Drawer is furnished with bill clip and brush type coin pad and locks with drop bolt through bottom of drawer into housing.

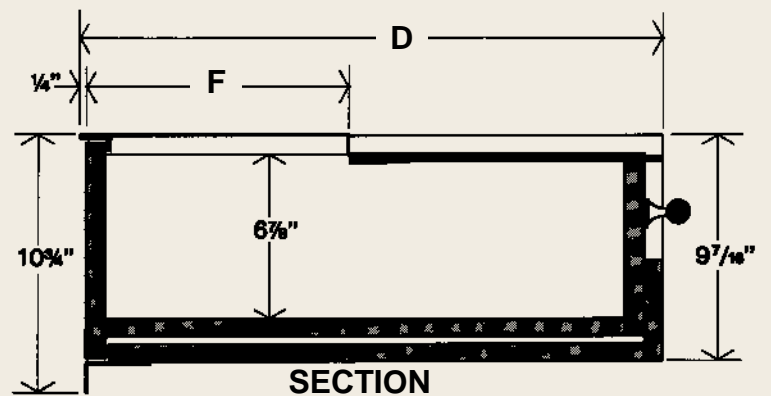

Model	DIMENSIONS	
	D	F
1724 WW	24 ¹ / ₄ "	11"
1728 WW	28 ¹ / ₄ "	15"

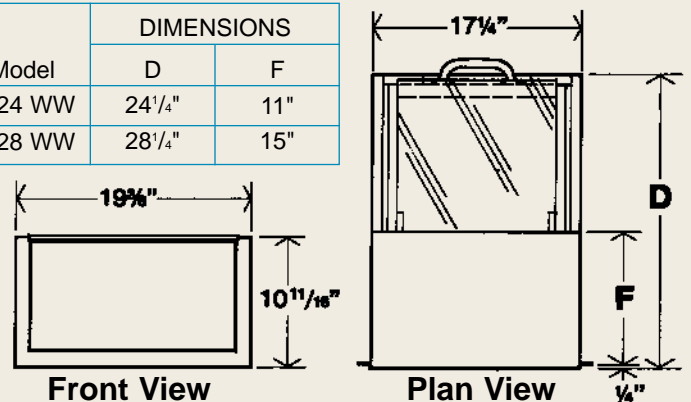

Transaction Drawer 1724-SCL

Patented

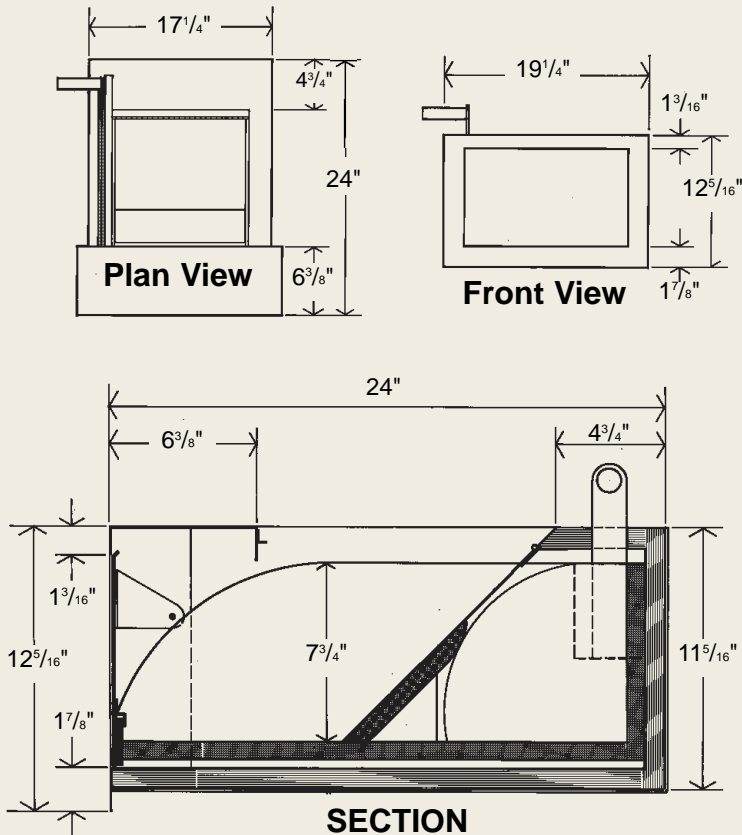

Patented Transaction Drawer No. 1724-SCL has its lid and front door synchronized to open and close with no chance of the lid being left open when drawer is extended. As drawer closes, the lid returns to slanted position allowing operator's access to contents.

Drawer constructed of bullet resistant plastic. Housing is 3/4" exterior plywood with stainless steel on exposed surfaces. Face, hood, lid, handle and coin scoop are stainless steel. Drawer has Class I bullet resistant protection.

Drawer extension: 14 1/4"

Wall opening size: 17 1/2" wide x 11 1/2" high.

Transaction Drawer 1724-SS

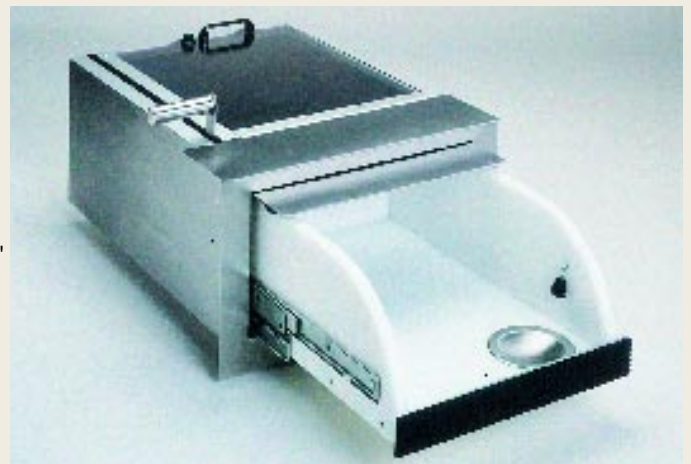
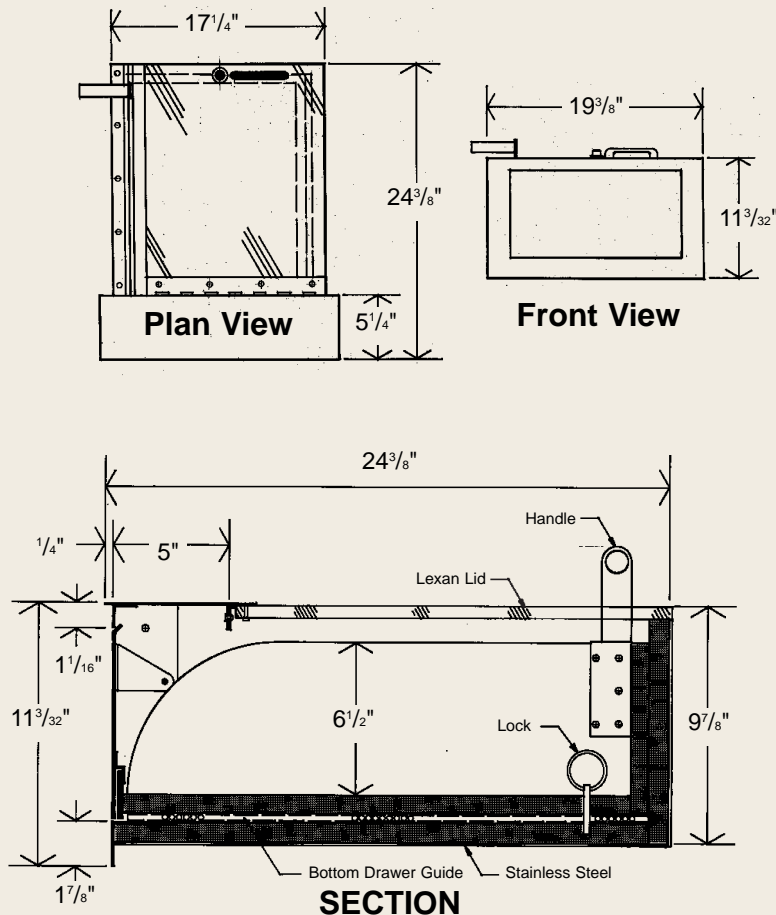

Transaction Drawer No. 1724-SS is suited for drive-up and walk-up service. This drawer is weather resistant. Lexan lid allows clear view of contents while preventing direct entry of outside air. Push button latch keeps lid locked when closed.

As drawer moves outward the stainless steel front panel pivots upward and inward. Drawer locks with drop bolt. Coin scoop and bill clip are included.

Drawer constructed of bullet resistant plastic. Housing is 3/4" exterior plywood with stainless steel on exposed surfaces. Face, hood, handle and coin scoop are stainless steel. Class I bullet resistant protection.

Drawer extension: 15"

Wall opening size: 17 1/2" wide x 10" high

Drawer inside dimensions: 13" wide x 22" deep x 6 1/2" high.

Transaction Drawer 2725-SS

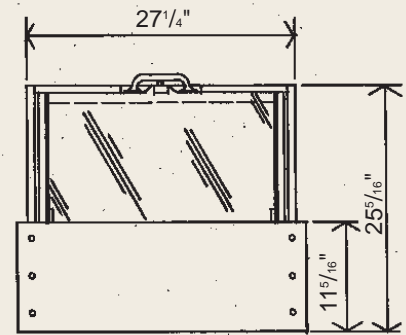
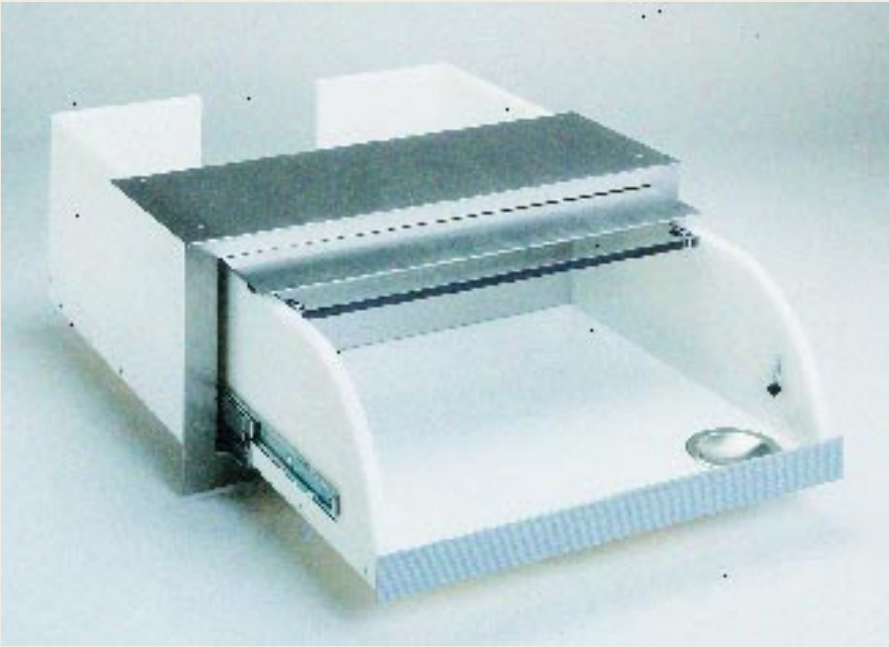

Plan View

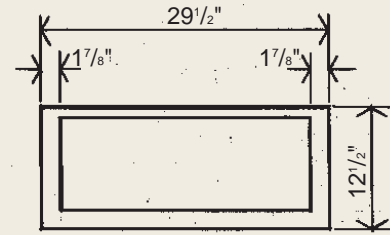

Front View

Transaction Drawer No. 2725-SS is designed for exterior walk-up and drive-up service. This drawer is weather resistant as well as bullet resistant. Stainless steel front panel pivots upward and inward as drawer moves outward. Movement is provided by smooth running extension slides. Drawer locks with a drop bolt. Coin scoop and bill clip are included. Clear Lexan lid allows clear view of contents.

Drawer is constructed of bullet resistant plastic.

Drawer extension: 19"

Wall opening size: 27³/₈" x 11¹/₂" high

Drawer inside dimensions: 23¹/₄" wide x 22¹/₂" deep x 7¹/₂" high

Class I bullet resistant

Door, frame, hood, and coin scoop are stainless steel.

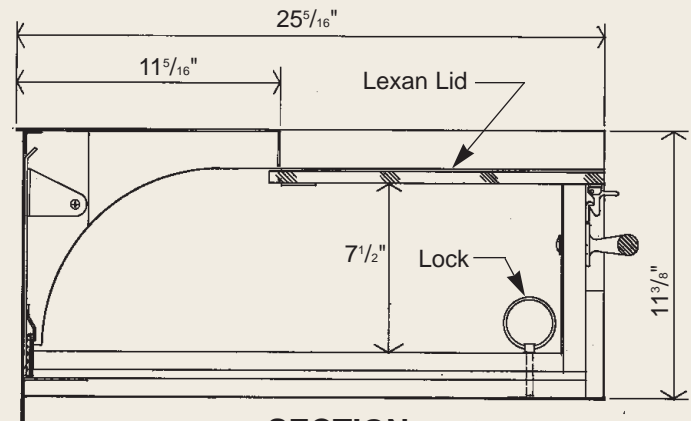

SECTION

Sliding Lid Model Deal Tray No. 1214 SL



Clear inside width: 10 3/8"
Clear inside height: 2 1/8"

Sliding lid deal tray is designed for maximum protection against all hand guns, including the .44 magnum. Stainless steel construction, lid slides forward or backward to uncover open deal tray below. Unit mounts on counter top, with customer's window positioned across the top center ledge above the lid.

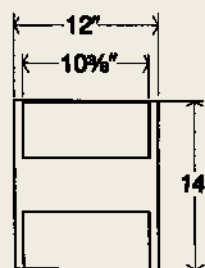

Plan View

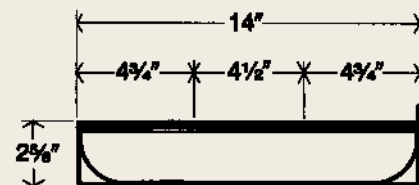

SECTION

Swivel-Thru No. 1 Combination Pass Thru and Deal Tray

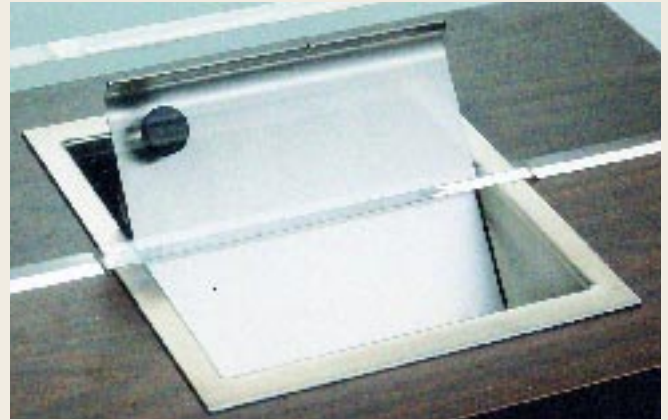
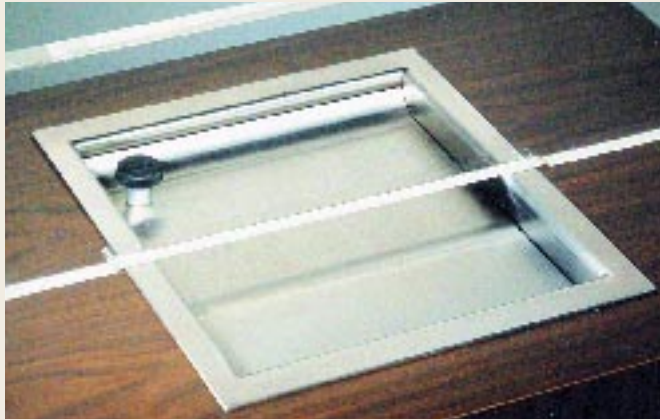

Stainless steel Swivel-Thru sets in transaction area of counter, centered beneath the bullet resistant window. For normal currency transactions the deal tray (lid) is locked in horizontal position by a turn latch incorporated in the knob. For larger items the deal tray is tilted upward to the lower edge of window to uncover the open drum below. After larger

item is placed in open drum, deal tray is rotated in opposite direction by operator for access to drum contents. The Swivel-Thru is bullet resistant in all positions. It has the appearance of an ordinary deal tray when mounted in place, not detracting from aesthetics of counter. Unit is large enough to accommodate items such as an eight pack of drinks or large bag of coins.

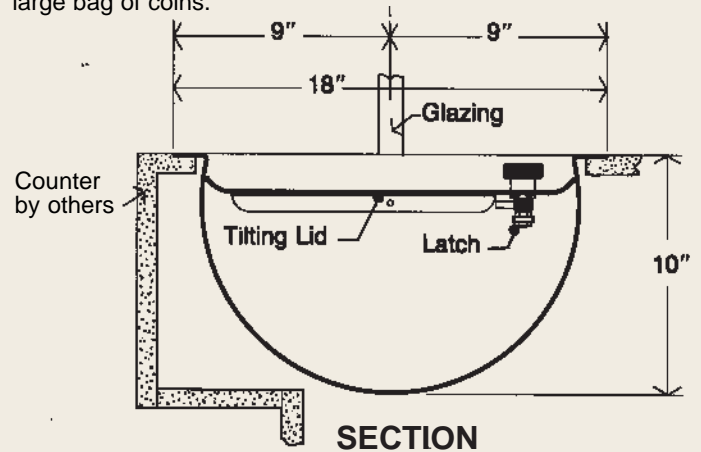
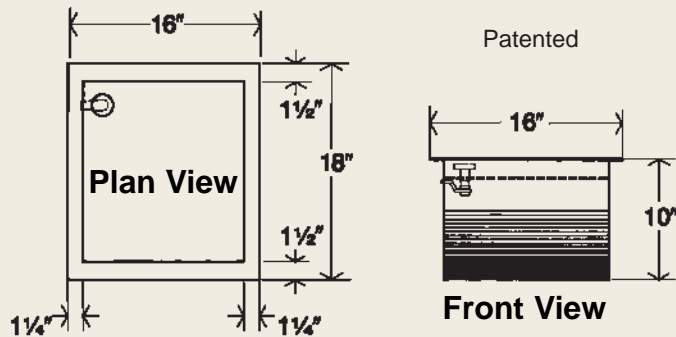

Recessed Deal Tray with Flip Lid FLR 1416

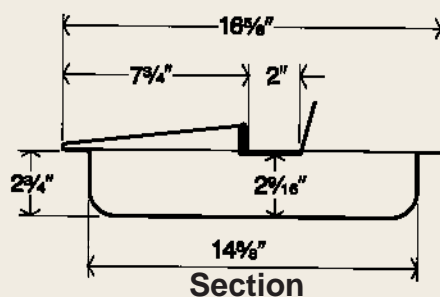
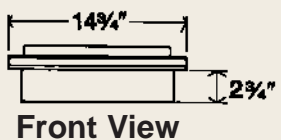
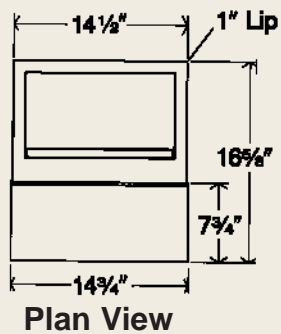

Recessed deal tray with flip lid is designed for outdoor use. This stainless steel unit mounts in counter top opening below window. Slanted lid on customer's side of window helps keep inside of deal tray dry. Downward push on rear pull opens deal tray to customer. Unit can handle items large as cigarette carton. Hole cut out size: 13" wide x 15" deep.

Stainless Steel Shelves

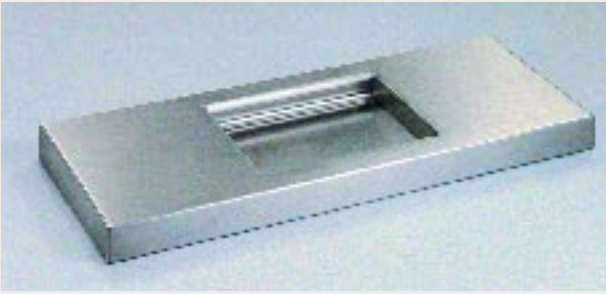

Shelf mounts below window to allow transfer of smaller items in the built-in deal tray.
 Shelf size: 12" deep x 2" high.
 Deal tray size: 11" x wide x 8¹/₄" deep x 1¹/₂" high.

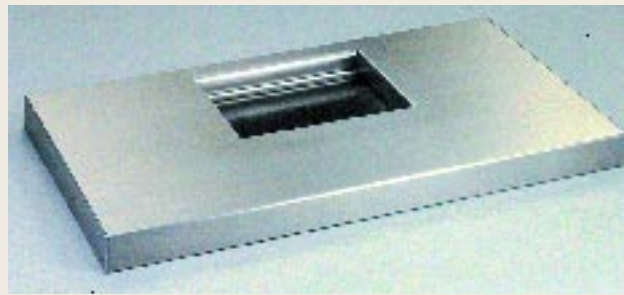
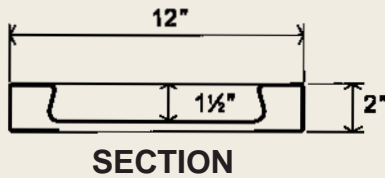

Shelf is 18" deep x 2" high, providing a 7¹/₂" deep writing surface in front of the built-in deal tray. Deal tray section is 11" wide x 8¹/₄" deep x 1¹/₂" high. Various widths.

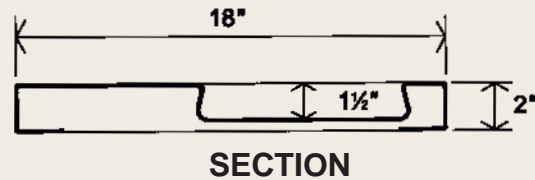

Model	W	D	H
24-SSS-12	24"	12"	2"
30-SSS-12	30"	12"	2"
36-SSS-12	36"	12"	2"
48-SSS-12	48"	12"	2"
60-SSS-12	60"	12"	2"
72-SSS-12	72"	12"	2"

Model	W	D	H
24-SSS-18	24"	18"	2"
30-SSS-18	30"	18"	2"
36-SSS-18	36"	18"	2"
48-SSS-18	48"	18"	2"
60-SSS-18	60"	18"	2"
72-SSS-18	72"	18"	2"

Deal Trays One Way Non-Ricochet



One-Way Non-Ricochet Deal Tray has an exclusive "S" shaped section on the operator's side. This allows a bullet to be directed back towards the window above the deal tray or back towards the gunman, depending upon the angle of impact. One-Way Non-Ricochet Deal Trays are available as Class I Ballistic level MPSA or Class III ballistic level SPSA units. Construction is stainless steel on these Drop-In models.

Class I bullet resistant
 Class III bullet resistant

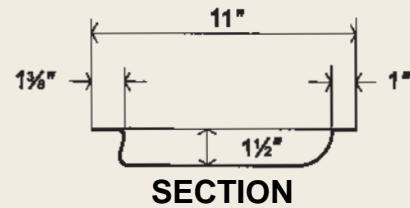

Class I bullet resistant			Cut Out Size
Model	W	D	W x D
1211-OW	12"	11"	10 ¹ / ₄ " x 9 ³ / ₈ "
1611-OW	16"	11"	14 ¹ / ₂ " x 9 ³ / ₈ "

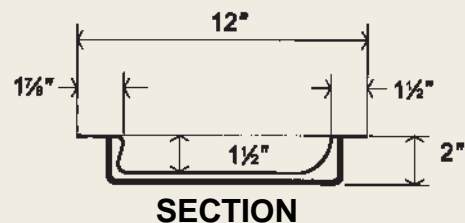

Class III bullet resistant			Cut Out Size
Model	W	D	W x D
1212-OW	12"	12"	10 ¹ / ₄ " x 10 ¹ / ₄ "
1612-OW	16"	12"	14 ¹ / ₄ " x 10 ¹ / ₄ "

Deal Trays

Counter Top Models

Deal Trays mount below bullet resistant window to allow transfer of currency and small items.

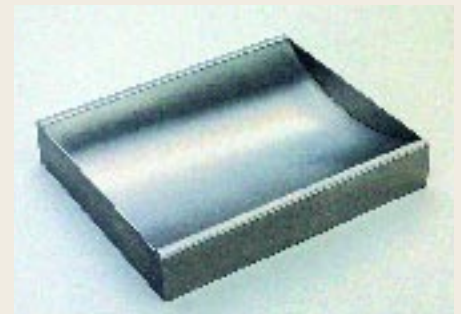
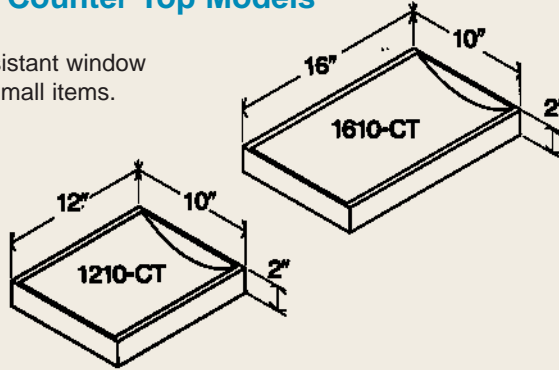
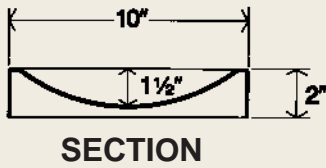

Stainless steel counter top model deal tray mounts up on top of counter. No cut out is required.

Deal Trays

Drop-in Models

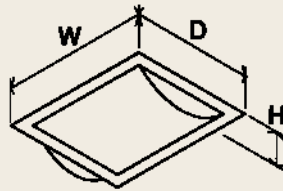
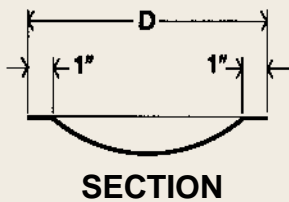

Model	W	D	H	W x D
1210-S	12"	10"	1 1/2"	10 1/2" x 8 1/2"
1610-S	16"	10"	1 1/2"	14 1/2" x 8 1/2"
1411-S	14"	11"	2 1/2"	12 1/2" x 9 1/2"

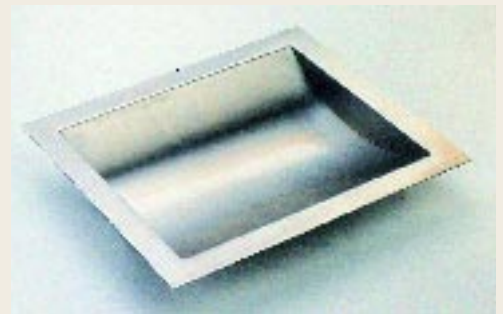

Stainless steel drop-in model deal tray is recessed into counter top opening for flush appearance.

Deal Trays Class III Protection

Drop-in Models

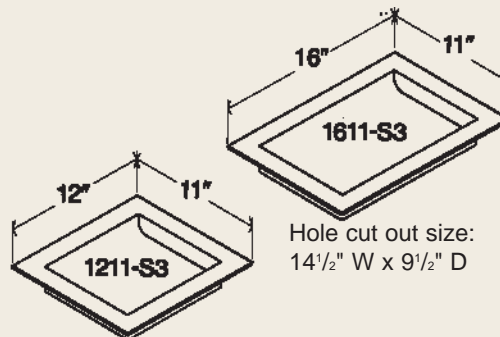
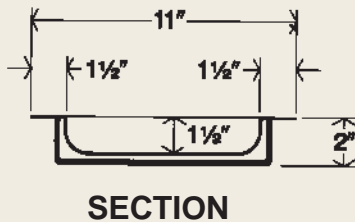

Hole cut out size:
10 1/2" W x 9 1/2" D

Hole cut out size:
14 1/2" W x 9 1/2" D

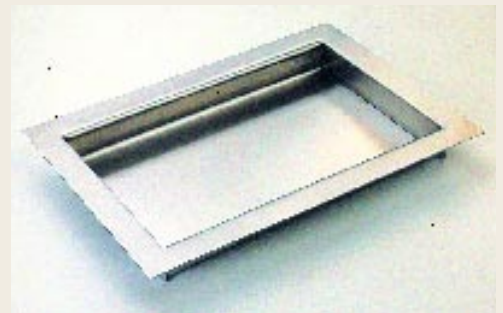

Stainless steel Class III deal tray recesses into opening in counter top.

Deal Trays Non-Ricochet

Drop-in Models

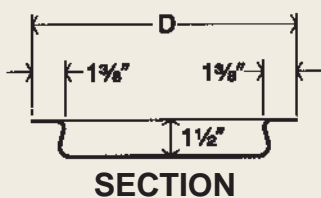

Class I bullet resistant protection

Model	W	D	W X D
<i>Class I</i> 1211-NR	12"	11"	Cut out size 10 1/4" x 9 1/4"
1611-NR	16"	11"	14 1/4" x 9 1/4"

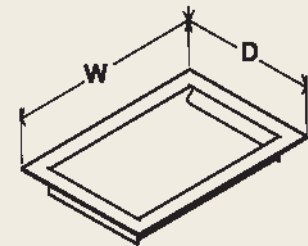

Non-ricochet deal tray has an exclusive "S" shaped section which allows a bullet to be contained within the deal tray or be directed back towards window above, depending upon the angle of impact. Available in Class I or Class III ballistic level. Stainless steel construction.

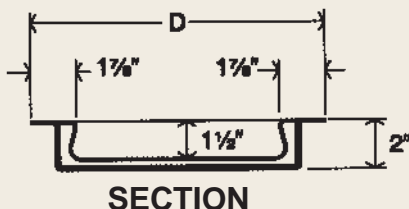

Class III bullet resistant protection

Model	W	D	W X D
<i>Class III</i> 1212-NR3	12"	12"	Cut out size 10 1/2" x 10 3/8"
1612-NR3	16"	12"	14 1/2" x 10 3/8"

Exterior Service Window

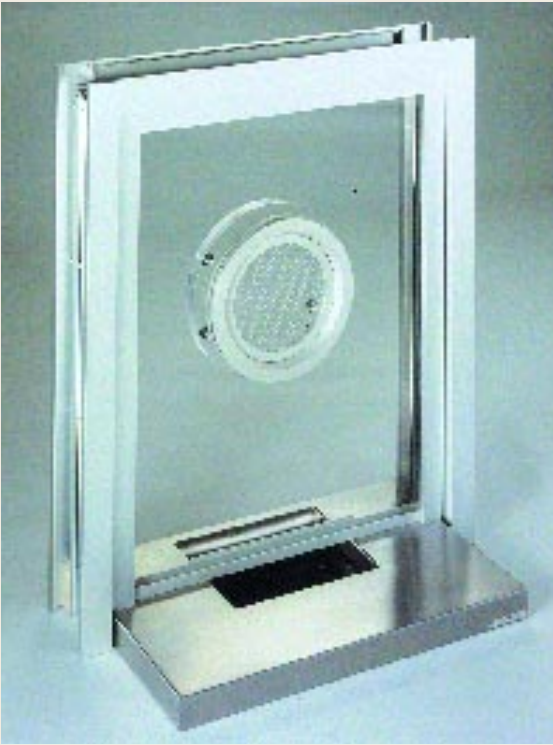

Exterior Service Window fits into rough wall opening and clamps onto wall. Adjustable extruded aluminum frame fits walls 5" to 8½" thick. Window clamps in place with bolts positioned through back frame into threaded section of front frame. Glazing is sealed into the frame for weather-tight installation. Stainless steel shelf has writing surface in front of built-in deal tray. Deal tray closure helps prevent drafts. Natural voice transmission is provided by the circular draft-free talk thru.

Frame available in clear or dark bronze anodized aluminum.

Bullet resistant glazing available: 1¼" acrylic Class I

or 1¼" Lexgard Class III

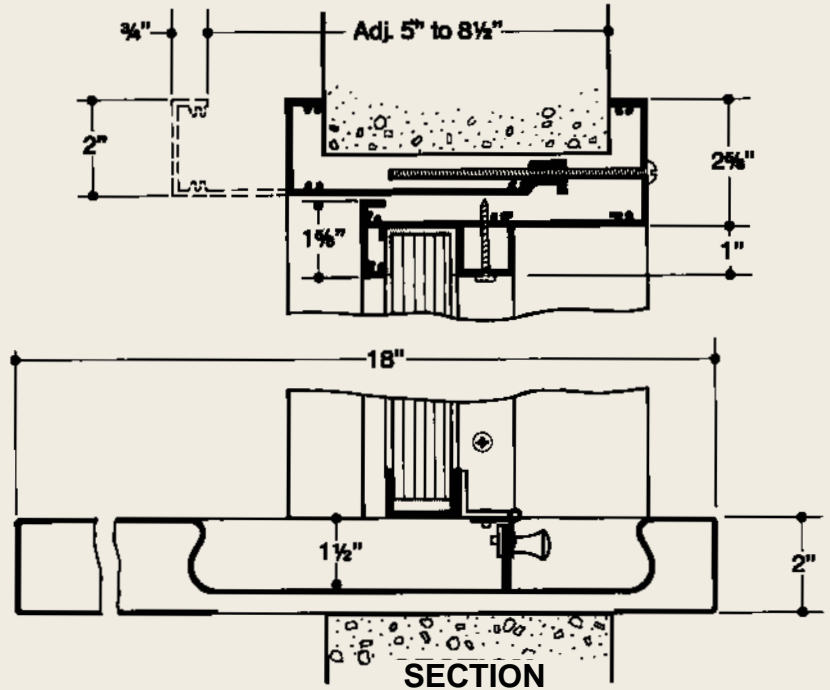

Model	Overall sizes of unit		Wall Opening	
	WxH		WxH	
SWE 2436	24"X36"		21¾"X35"	
SWE 3036	30"X36"		27¾"X35"	
SWE 3636	36"X36"		33¾"X35"	
SWE 2442	30"X42"		21¾"X41"	
SWE 3042	32"X42"		27¾"X41"	
SWE 3642	36"X42"		33¾"X41"	

Exterior Service Window with Multi-Lights



Exterior Service Window with Multi-Lights has adjustable aluminum clamp-on frame to fit wall 5" to 8¼" thick. Mullions divide window into two or more lights.

Glazing is sealed into frame for weather-tight installation. Draft-free circular talk thrus allow natural voice communication. Stainless steel shelf has recessed deal trays with closures.

Bullet resistant glazing: 1¼" acrylic Class I

or : 1¼" Lexgard Class III.

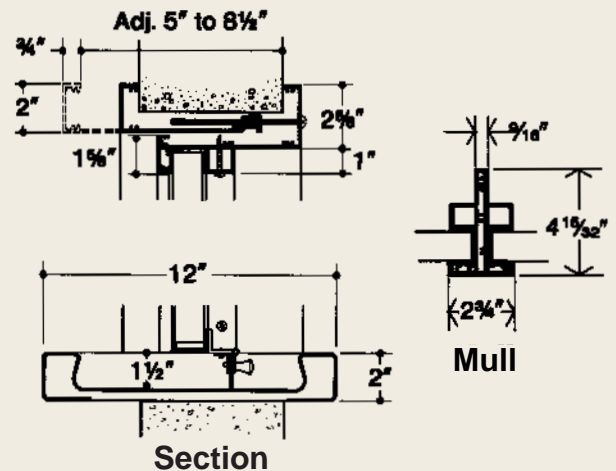

Model	Overall sizes of unit		Wall Opening	
	WxH		WxH	
SWE-ML 7236	72"X36"		69¾"X35"	
SWE-ML 8436	84"X36"		81¾"X35"	
SWE-ML 9636	96"X36"		93¾"X35"	

Nite Windows



**Nite Window with
Pass Hopper**

NW-PH 1632 Nite Window with Pass Hopper

Nite window with Pass Hopper fits into wall opening of 16¹/₄" x 32¹/₄". Aluminum frame has clear or dark bronze anodized finish. Unit includes PHE-1 stainless steel Pass Hopper, weather-stripped for exterior use and our 6-FR stainless steel draft free talk thru. Window has 1¹/₄" thick Class I bullet resistant acrylic glazing.

See Pass Hopper information shown on page 14.

NW-DT 1624 Nite Window with Deal Tray

Compact Nite Window fits into 16¹/₄" x 24¹/₄" wall opening. Glazing is 1¹/₄" thick acrylic with Class I bullet resistant protection and aluminum frame in clear or dark bronze anodized finish.

Window unit has No. 6-FR stainless steel draft free talk thru and stainless steel deal tray with hinged draft closure.



**Nite Window with
Deal Tray**

Vision Window

Vision Windows are available in single, double or triple lights. Corner and bay windows are available upon request. Window frame is extruded aluminum fastened together with screws, available in clear or dark bronze anodized finish. Vision windows are shipped without glazing material permanently installed. Glazing material must be sealed into framing after frame is anchored in place. Sealant to be furnished by installer.

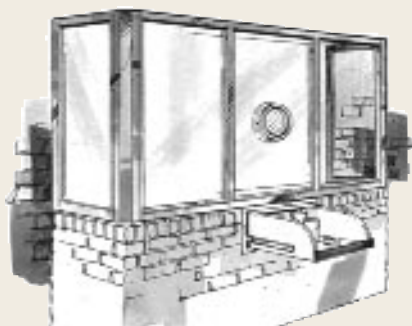
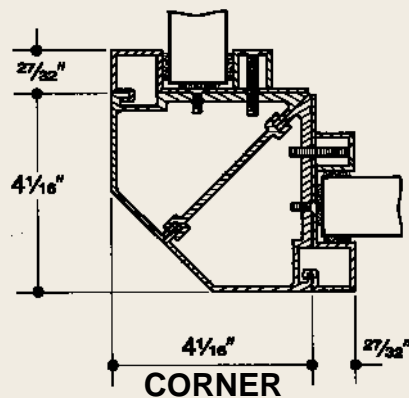
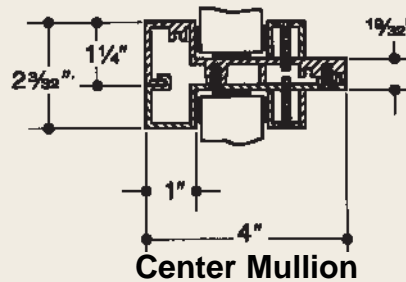
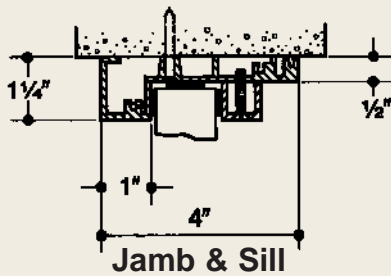

Vision window provides walk-up or drive-up service with the addition of circular talk thru and transaction drawer.



	Model	W x H
Single Lite	VWS 2436	24" x 36"
	VWS 3036	30" x 36"
	VWS 3636	36" x 36"
	VWS 4836	48" x 36"
	VWS 6036	60" x 36"
Double Lite	VWS-2 9636	96" x 36"
	VWS-2 12036	120" x 36"
Triple Lite	VWS-3 14436	144" x 36"
	VWS-3 18036	180" x 36"

Exchange Window



Exchange Window with natural voice transmission mounts into masonry opening or into bullet resistant reinforced stud wall. It can be made in single or multiple lites. The window frame is extruded aluminum and is fastened together with screws. Glazing material is held in place with rubber spacers which provide open space around side and top for natural voice transmission. Stainless steel shelf with built-in deal tray fits below window lite. Choice of bullet resistant glazing. Frame is available in clear or dark bronze anodized finish.

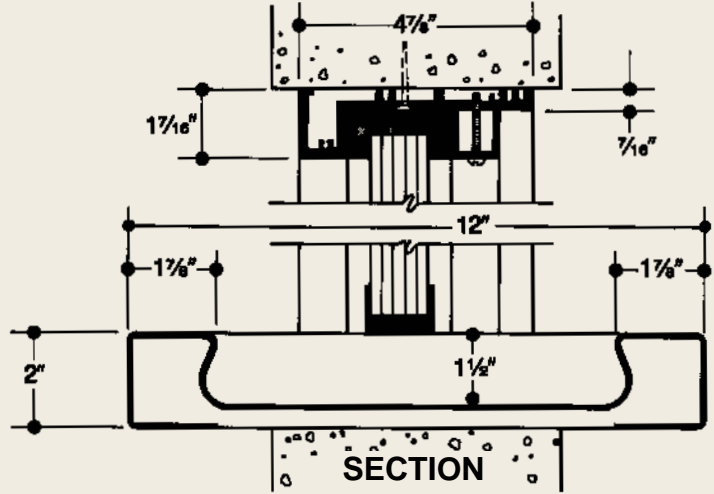

Exchange Window is for interior use only.

Model	W x H	Model	W x H
XW 2430	24" x 30"	XW 2436	24" x 36"
XW 3030	30" x 30"	XW 3036	30" x 36"
XW 3636	36" x 36"	XW 3636	36" x 36"
		XW 4836	48" x 36"
		XW 6036	60" x 36"
		XW 7236	72" x 36"

Exchange Window with Multi-Lites. Available in custom sizes. Priced upon application.

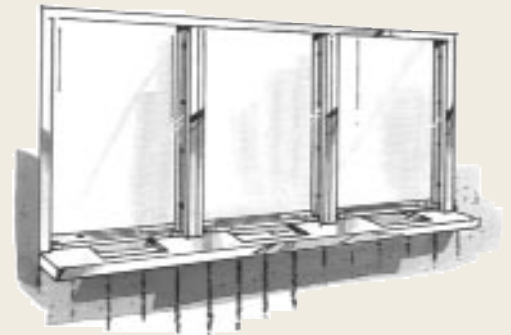

Exchange Vision Window



Exchange Vision Window has natural voice transmission. This window is identical to Exchange Window above except the shelf is omitted and replaced with aluminum frame along bottom edge.

For interior use only.

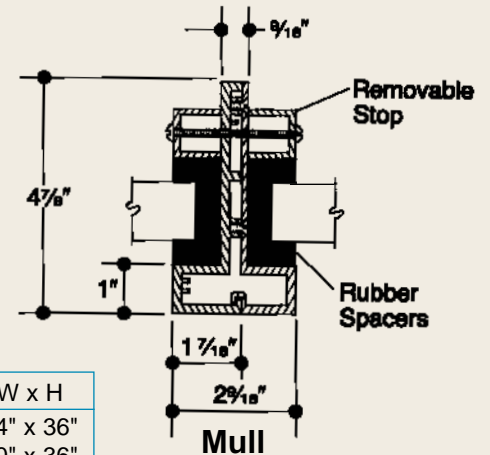
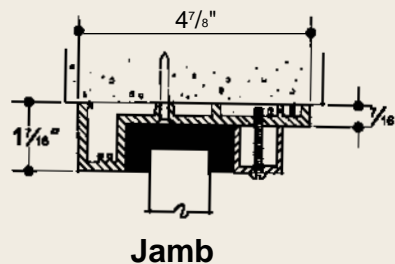

Model	W x H	Model	W x H
XW 2430	24" x 30"	XW 2436	24" x 36"
XW 3030	30" x 30"	XW 3036	30" x 36"
XW 3636	36" x 36"	XW 3636	36" x 36"
		XW 4836	48" x 36"
		XW 6036	60" x 36"

Exchange Window with Lazy Susan

This double light window unit is for interior use only. Window has natural voice transmission inside aluminum frame. Deal tray is provided for currency transactions while Lazy Susan* pass thru handles larger items for transfer. Choice of plastic laminate on shelf. Choice of glazing. Frame available in clear or dark bronze anodized finish.

Overall size is 36" wide x 36" high.
Other sizes available

*Lazy Susan is described in further detail in another section of this brochure.

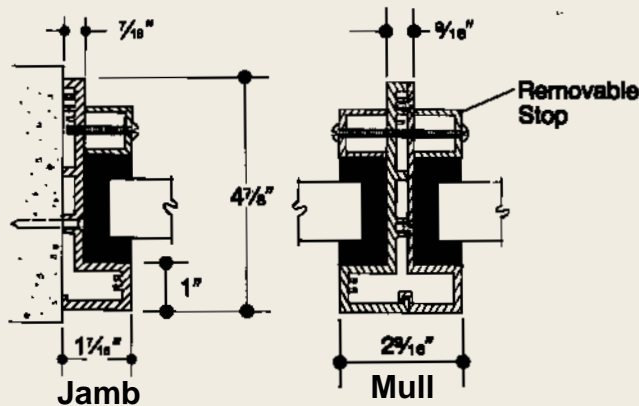

Exchange Window with Hinged Panel

Exchange window with natural voice transmission has hinged panel which swings up for transfer of larger items. Stainless steel shelf with integral deal tray fits below window.

Hinged panel is 15" wide x 6" high.

Note: GLASS IS NOT AVAILABLE for exchange Window with Hinged Panel. Specify Class I-1 1/4" thick acrylic or Class III-1 1/4" thick Lexgard. *This window is for interior use only.*



Lock detail

Channel shaped pull protects against tampering with slide bolt lock.

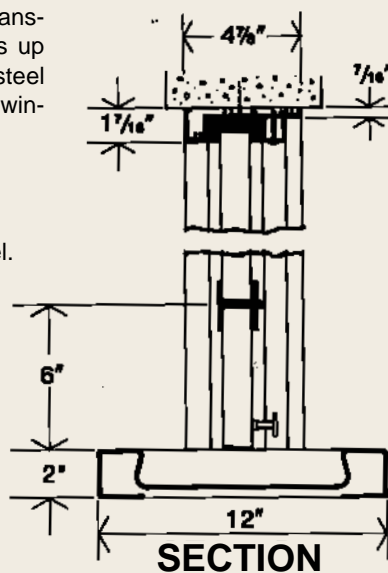

Model	W x H
XW-HP 2430	24" x 30"
XW-HP 3030	30" x 30"
XW-HP 3630	36" x 30"
XW-HP 2436	24" x 36"
XW-HP 3036	30" x 36"
XW-HP 3636	36" x 36"



Service Window with Aluminum Clamp-On Frame

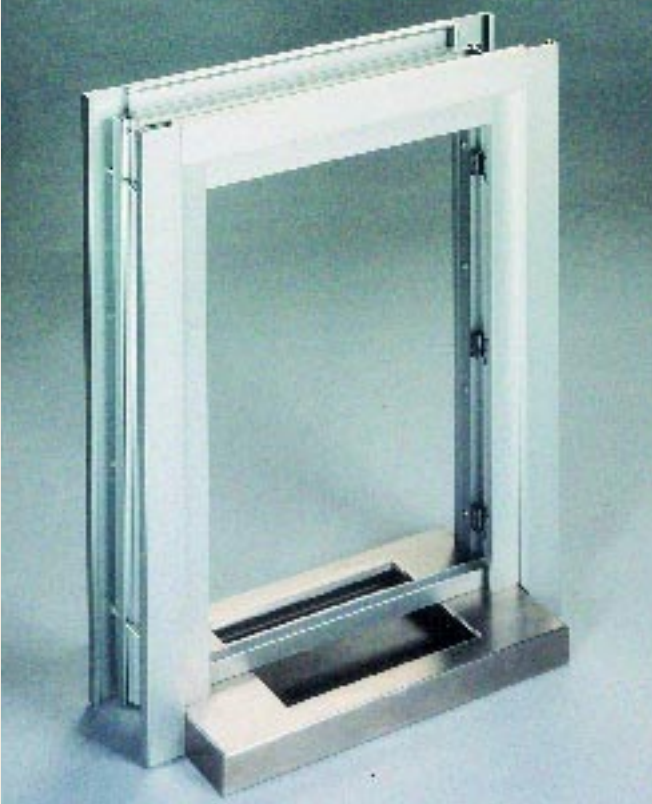

Bullet resistant Service Window fits into rough wall opening and clamps onto finished wall. Extruded aluminum frame adjusts for walls 5" to 8 1/2" thick. Window unit clamps into place with bolts positioned through back frame into threaded section of front frame.

Glazing is held in place with rubber spacers, providing space around sides and top for natural voice transmission. Stainless steel shelf with built in tray is fastened to frame.

Choice of glazing. Frame available in clear or bronze anodized. Entire unit is shipped fully assembled.

This model is for interior use only.

Model	Overall size of unit	Wall opening
	W x H	W x H
SWA 2436	24" x 36"	21 ³ / ₄ " x 35"
SWA 3036	30" x 36"	27 ³ / ₄ " x 35"
SWA 3636	36" x 36"	33 ³ / ₄ " x 35"
SWA 4836	48" x 36"	45 ³ / ₄ " x 35"
SWA 6036	60" x 36"	57 ³ / ₄ " x 35"
SWA 7236	72" x 36"	69 ³ / ₄ " x 35"
SWA 3042	30" x 42"	27 ³ / ₄ " x 41"
SWA 3642	36" x 42"	33 ³ / ₄ " x 41"
SWA 4842	48" x 42"	45 ³ / ₄ " x 41"
SWA 6042	60" x 42"	57 ³ / ₄ " x 41"
SWA 7242	72" x 42"	69 ³ / ₄ " x 41"

Special sizes are available upon application.

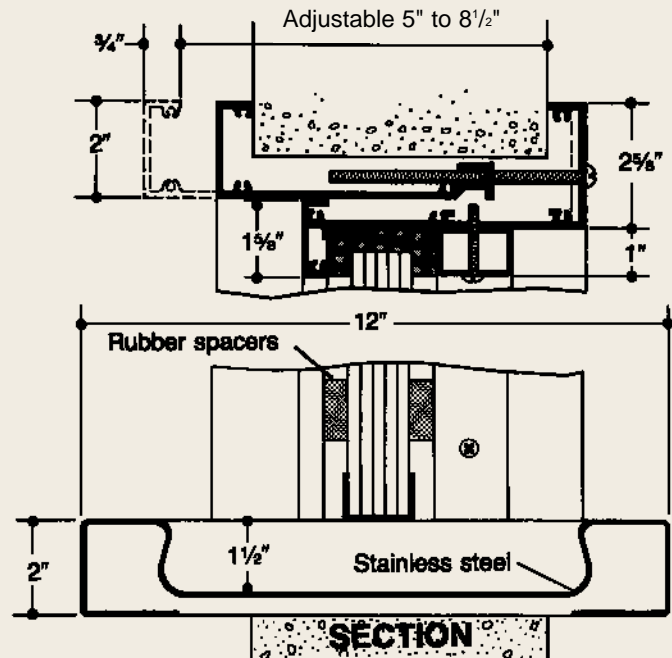

Vision Window with Aluminum Clamp-On Frame



Bullet resistant Vision Window with Aluminum Clamp-on Frame is identical to our Service Window above except for a frame along bottom in place of stainless steel shelf and deal tray.

Model	Overall size of unit	Wall Opening
	W x H	W X H
VWACL 2436	24" x 36"	21 3/4" x 33 3/4"
VWACL 3036	30" x 36"	27 3/4" x 33 3/4"
VWACL 3636	36" x 36"	33 3/4" x 33 3/4"
VWACL 4836	48" x 36"	45 3/4" x 33 3/4"
VWACL 6036	60" x 36"	57 3/4" x 33 3/4"
VWACL 7236	72" x 36"	69 3/4" x 33 3/4"
VWACL 3042	30" x 42"	27 3/4" x 39 3/4"
VWACL 3642	36" x 42"	33 3/4" x 39 3/4"
VWACL 4842	48" x 42"	45 3/4" x 39 3/4"
VWACL 6042	60" x 42"	57 3/4" x 39 3/4"
VWACL 7242	72" X 42"	69 3/4" x 39 3/4"

Ticket Window

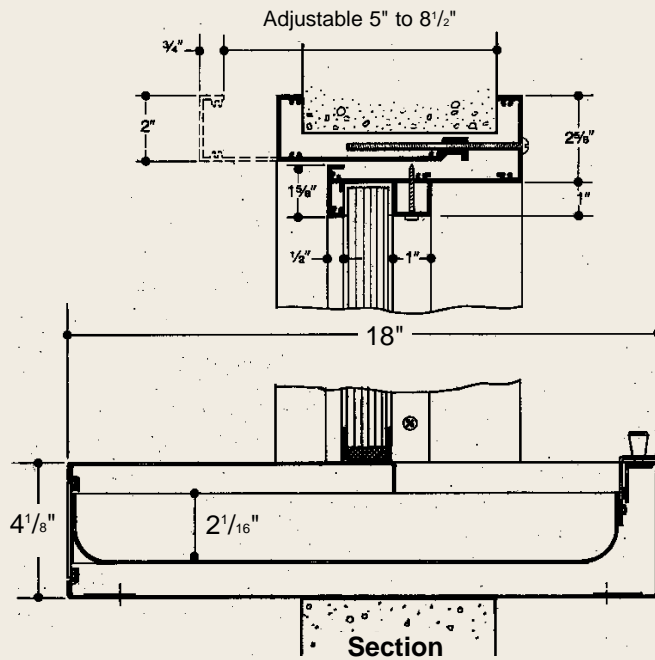

Creative Industries, Inc.'s new bullet resistant Ticket Window features aluminum clamp-on frame adjustable for walls 5" to 8 1/2" thick, two-way voice amplified bullet resistant talk through is mounted in choice of glazing. The unique patent pending counter top and drawer combination is constructed of stainless steel and weather-stripped to minimize energy loss. Drawer moves forward quietly on solid bearing slides and blends smoothly into frontal surface of shelf when closed, making desirable flush appearance. Counter top extends in front of window to provide customer with extra space for writing surface or purse ledge. Window frame is available in clear or dark bronze anodized finish.

Model	Overall size	Wall Opening
	W x H	W x H
TIK 2436	24" x 36"	21 3/4" x 35"
TIK 2442	24" x 42"	21 3/4" x 41"
TIK 2448	24" x 48"	21 3/4" x 47"

Walk up Window

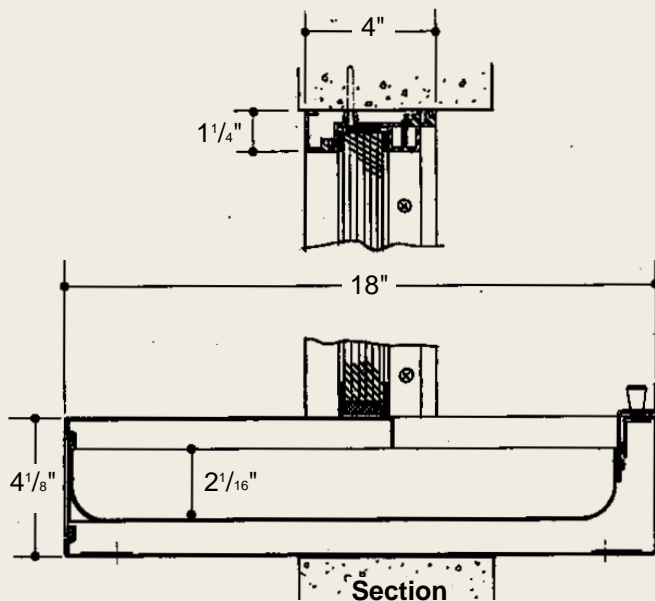

Creative's new bullet resistant Walk-Up Window has aluminum frame. Patent pending stainless steel counter top with drawer leaves space in front of window for writing surface or purse ledge. Weather-stripped drawer extends out to customer for access to contents.

Natural voice transmission is furnished by Creative's patent pending Model No. 5-D cast stainless steel talk thru. Walk-up Window is shipped without glazing material permanently installed. Sealant is to be furnished by installer.

Model	Overall size	Wall Opening
	W x H	W x H
WU 2436	24" x 36"	24 1/4" x 36 1/4"
WU 3036	30" x 36"	30 1/4" x 36 1/4"
WU 3636	36" x 36"	36 1/4" x 36 1/4"

Counter Top with Drawer

Patent Pending

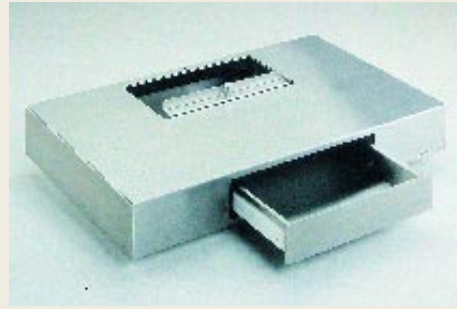
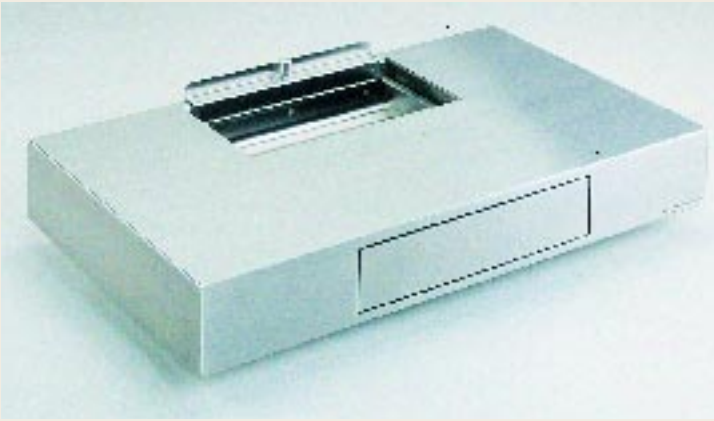

Stainless steel counter top with built-in drawer (patent pending) is ideal for stadiums, motels, banks or gas stations. Ample space is provided on top for writing surface. Drawer moves quietly on solid bearing slides and blends smoothly into front of counter top when closed. Drawer locks via turn latch in handle. Unit is weather-stripped to hold energy loss to a minimum. Inside drawer dimensions are 11⁷/₈" wide x 16" deep x 2¹/₁₆" high. Class I bullet resistant.

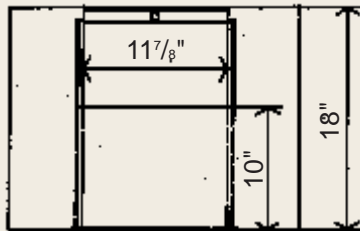

Plan View

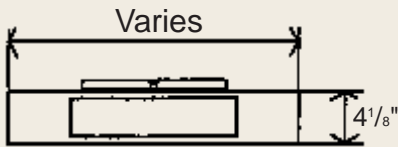

Front View

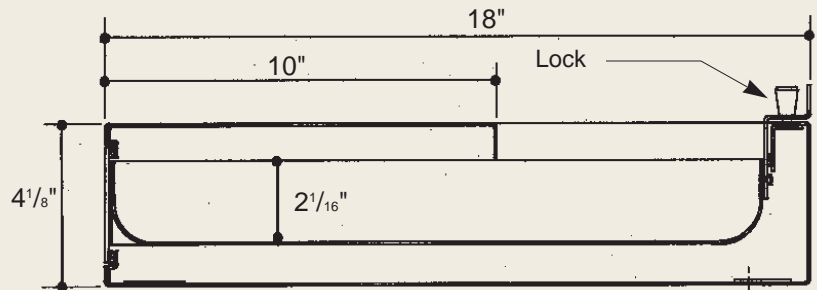

SECTION

SC-100 Talk Thru

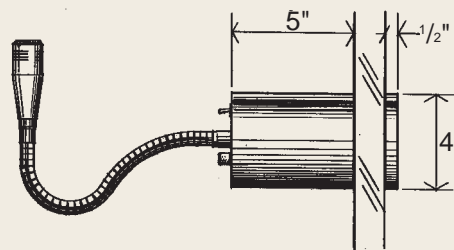

Side View

Four inch diameter aluminum anodized two-way electronic talk thru provides amplified clear voice communication. Standard model has gooseneck microphone for operator and plugs into 115 volt duplex outlet for continuous duty. Battery pack is available for DC operation (specify model SC-100L). Indicate glass thickness when ordering. Requires 3 1/2" diameter hole. SC-100 provides Class III bullet resistant protection.

5-FR Talk Thru

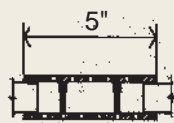

SECTION

Five inch diameter stainless steel talk thru has offset slots in front and rear to provide natural voice transmission. No. 5-FR Talk Thru is available as interior or exterior model (specify which) and fits glass from 1/4" to 1 1/4" thick. Indicate glass thickness when ordering. Requires 4" diameter hole. Level I bullet resistant.

No. 5-D Talk Thru

Patent Pending

Five inch diameter cast stainless steel talk thru with vertical louvers provides natural voice transmission. No. 5-D Talk Thru is available for interior or exterior use (specify which) and fits glazing from $\frac{1}{4}$ " to $1\frac{7}{8}$ " thick. Optional security screws and contraband screen are available.

Please indicate glass thickness when ordering talk thru.

Requires 4" diameter hole.

Class III bullet resistant.

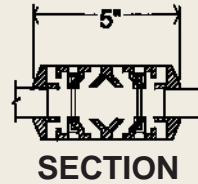

No. 6-FR Talk Thru

Six inch round stainless steel talk thru has offset holes in front and rear to allow natural voice transmission. No. 6-FRTalk Thru is available as interior or exterior model (specify)

It fits glass from $\frac{1}{4}$ " to $1\frac{7}{8}$ " thick.

Denote glass thickness of window when ordering talk thru.

Requires 5" diameter hole.

Class I or III bullet resistant.



SECTION



No. 6-D Talk Thru

Round 6" diameter cast stainless steel talk thru design offers natural voice transmission with evenly spaced concentric louvers. This unit is available as interior or exterior model (specify). No. 6-D Talk Thru is adjustable for $\frac{1}{4}$ " to $1\frac{7}{8}$ " thick glass. Glass thickness less than $1\frac{3}{16}$ " requires optional spacer ring.

When ordering indicate glass thickness of window.

Requires 5" diameter hole.

Class III bullet resistant.

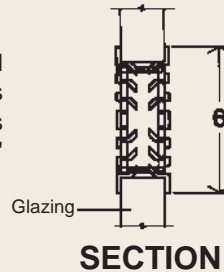

SECTION



No. 8-D Talk Thru

Draft Free $8\frac{3}{8}$ " diameter cast aluminum talk thru is well suited for exposed application. Natural voice transmission is obtained through the tensed clear plastic diaphragm while eliminating air flow. Perforated clear security screen on customer side protects the diaphragm. Talk thru has bullet resistive shield on rear side.

Unit is adjustable for glazing from $\frac{1}{4}$ " to $1\frac{7}{8}$ " thick. Optional spacer ring is required for glass less than $1\frac{3}{16}$ " thick.

Denote glass thickness of window when ordering.

Specify finish: clear or dark bronze anodize.

Requires $7\frac{1}{2}$ " diameter hole.

Class I or III bullet resistant.

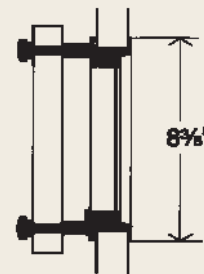

SECTION



No. 11- D Talk Thru

Draft free 11" diameter cast aluminum talk thru is meant for exterior installations. This model is larger version of our Model No. 8-D. 11-D Talk Thru is adjustable for glazing from $\frac{1}{4}$ " to $1\frac{7}{8}$ " thick. It requires optional spacer ring for glass less than $1\frac{3}{16}$ " thick.

Indicate window glass thickness when ordering talk thru.

Specify finish: clear or dark bronze anodize.

Requires 10" diameter hole.

Class I or III bullet resistant.

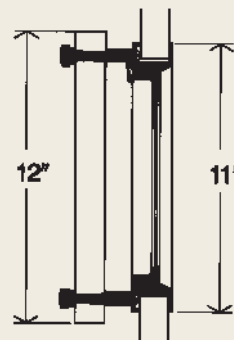

SECTION



Energy Pal Pass Thru Non-Bullet Resistant

Patented

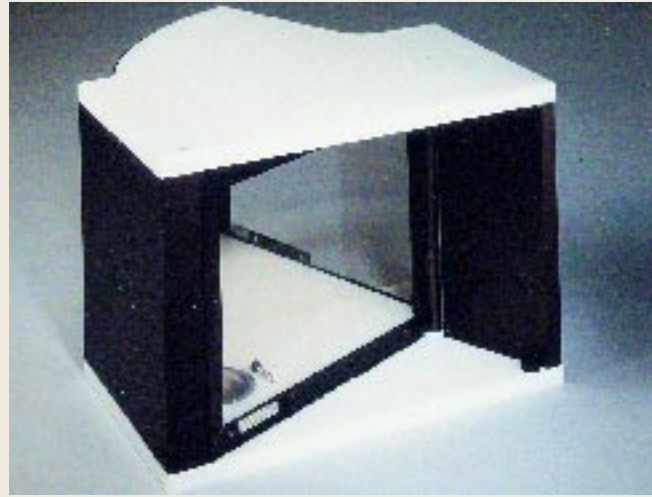

Creative's Energy Pal is ideally suited for drive-up service. The pivoting shelf with Lexan doors turns outward to customer and inward to operator. Shelf has coin scoop and bill clip. Energy Pal prevents direct entry of outside air into the building. Energy Pal mounts on window ledge or wall opening for drive-up service. It locks with the adjacent Lexan windows forming an insulated barrier between outside and inside air. unit is weather stripped.

Energy Pal has 13" inside clear height.

Construction:

Sides: Aluminum with clear or bronze anodized finish top and bottom:

1" thick solid plastic

shelf: Solid plastic

Doors: Clear 1/4" thick Lexan

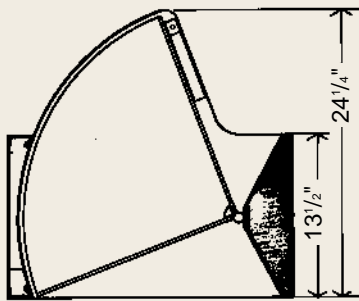
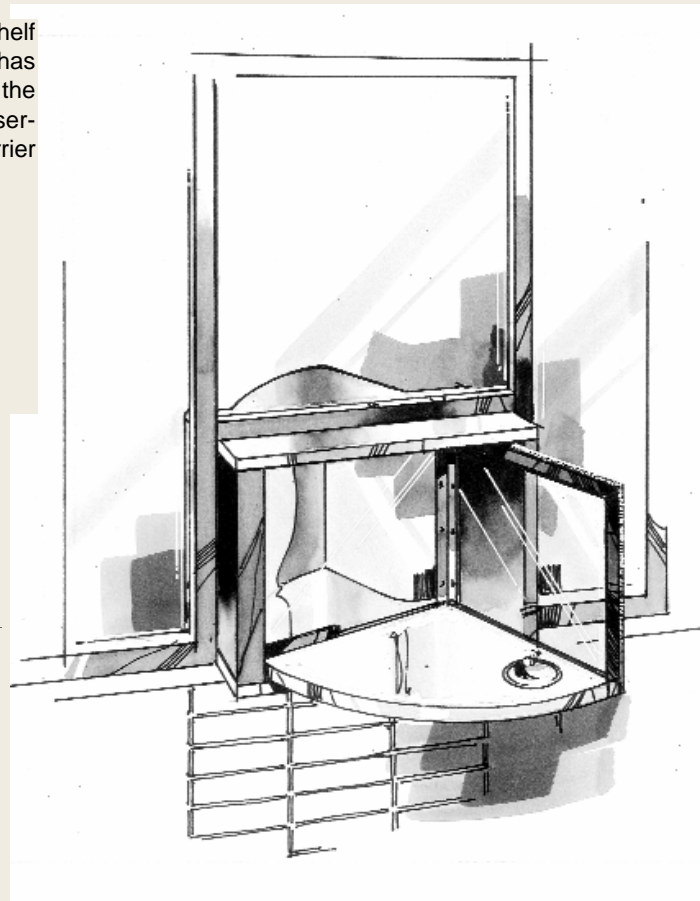

Plan View Section

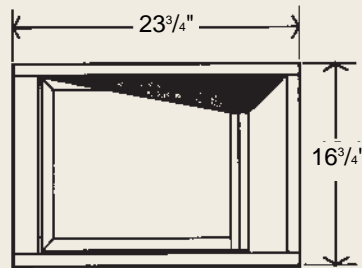

Front View

Recessed Deal Tray with Sliding Lid RSL 1414

Stainless steel recessed deal tray unit mounts flush in counter top with window (by others) centered above. Sliding lid has full width flange across rear which acts as handle. The lid slides on solid bearings, forward or backward to uncover desired section of deal tray below. Lid offers extra protection and helps minimize heat or cooling loss.

Deal Tray can accommodate item up to 10 1/2" wide by 4" deep by 2" high.

Overall size: 14" wide x 14" deep x 2 1/2" high.

Counter top opening size: 12 1/4" wide x 12 1/4" deep.

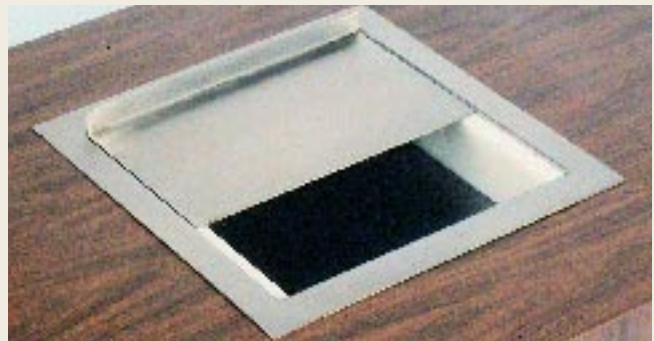

Flip Window Non-Bullet Resistant

The Flip Window is designed to allow less entry of outside air into the building than a normal sliding window. The window pivots for easy opening and closing. When open the front edge of window extends out only 8 1/2" from sill. Flip Window mounts between mullions for retrofit. Choice of glazing 1/4" Lexan or 1/4" tempered glass. The window locks with spring loaded dead bolt and has brush type weatherstrip. Frame available with clear or bronzed anodized aluminum. Standard size is 21 3/4" wide x 21" high overall with a clear opening of 15 1/2" wide x 17 1/2" high. Custom sizes are available.

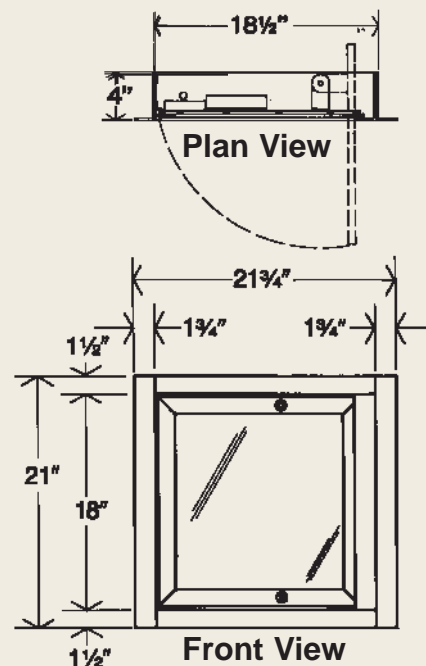

Flip Window with Transom Non-Bullet Resistant

For new construction or retrofit, this unit can replace movable section of existing sliding window, reducing the size of the window which opens to the customer. Custom sizes and configuration available upon application. Standard size is 24" wide x 36" high overall.

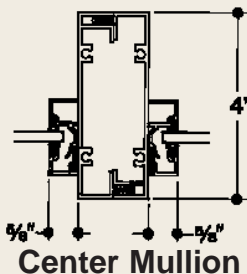
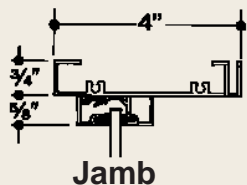
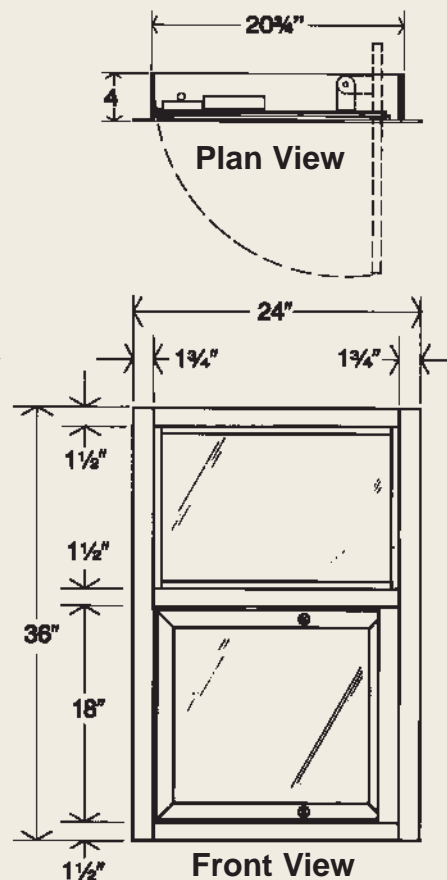

Illustration of Flip Window with Transom shown between two side lites.



Example of Flip Window below full width transom.

Bullet Resistant Teller Counter Model BRTC-SWTH



Bullet Resistant Teller Counter Model BRTC-SWTH is furnished with Swivel-Thru #1 combination Pass thru and deal tray. It has a natural voice transmission acrylic panel at deal area, with acrylic panels above risers set in aluminum frames. Teller counter unit includes counter

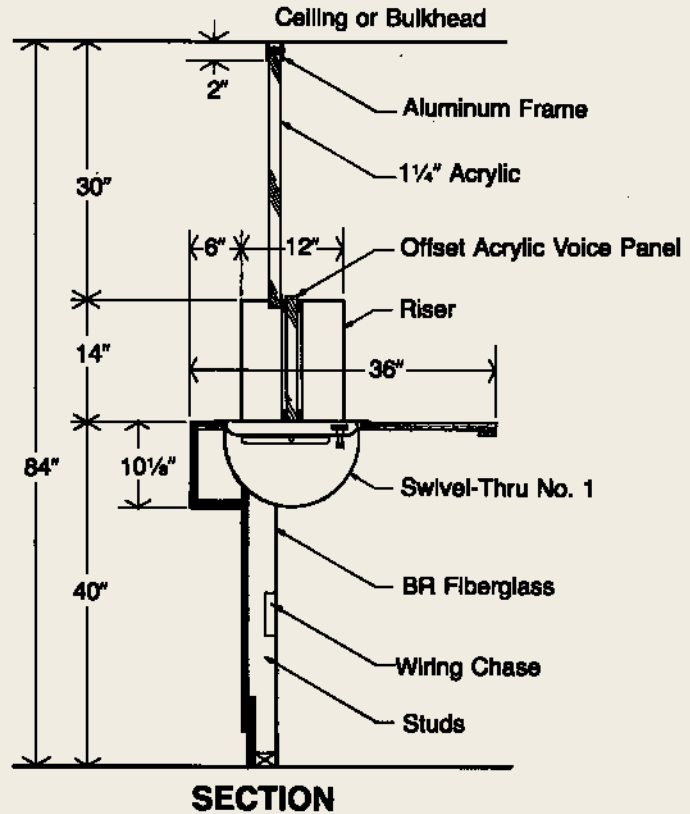

top, risers and counter front with bullet resistant fiberglass panels on rear side. Electrical duplex outlets are mounted on rear side of risers (wiring by others). Standard unit is 60" wide x 84" high, Class I bullet resistant protection with 1 1/4" thick acrylic glazing.

Warranty

Creative Industries, Inc. warrants its products to be free from defects in material and workmanship under normal use and service for a period of (1) one year from the date of shipment.

Creative Industries, Inc. agrees to replace or repair the defective part(s) F.O.B. place of shipment or repay, upon return of the defective part(s), the price paid for the same by the purchaser. This does not include labor cost incurred in replacement.

Creative Industries Inc

1024 Western Drive . Indianapolis, In. 46241
(800) 776-2068
(317) 248-1102
FAX (317) 247-4953
<http://www.creativeind.com>

© Creative Industries Inc 1997
No reproduction permitted without expressed written permission.